

# LCFH SERIES RESIDENTIAL LIGHTING

## LCFH-3LR-MCT5

TRIPLE ROUND, INTEGRATED 3 LIGHT LED SQUARE HOLOGRAM GLASS MULTIPLE PENDANT



Selection:



Integrated LED glass pendant is a contemporary and stylish design that can be used by itself as an accent piece, or grouped together to light a kitchen island, bar, or pool table.

Customer Name: \_\_\_\_\_

Project Name: \_\_\_\_\_

Note: \_\_\_\_\_

Type: \_\_\_\_\_

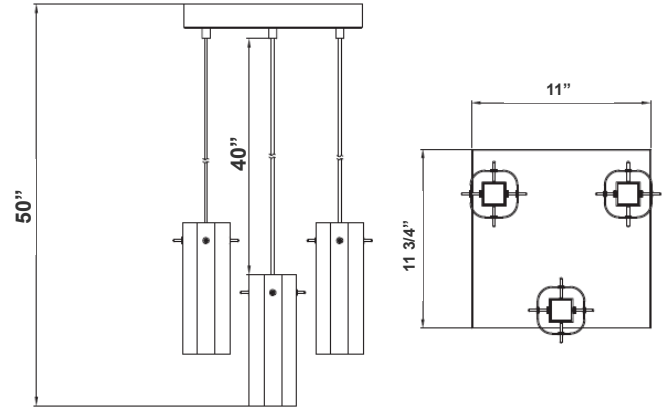

**50" H x 11" W**

## Features

- Multi CCT (Selectable Switch on the LED Board under the lens )
- Brushed Nickel Finish
- 5-Year Warranty
- Polycarbonate lens
- Triple w/ Round Canopy

## Technical Specifications

### Electrical:

- Voltage: 120V AC 50/60Hz
- Wattage: 36W
- Power Factor: >0.90
- Efficacy: 68 LPW

### Mechanical:

- Brushed Nickel Finish
- Glass Material: 5/64" (2mm) thickness, Ultra ClearGlass
- Power Cord is 60" Long
- Maximum Ambient Temperature: -22°F to 104°F
- IP20 indoor only

### Lighting:

- Dimming: TRIAC Dimming (Dimmable Down to 5% Compatible with Traic and ELV Dimmers)
- Total Lumens: 2430LM
- Color Temperatures: 2700K/3000K/3500K/4000K/5000K
- Multi CCT (Selectable Switch on back of the fixture )
- Color Rendering Index: CRI ≥ 90
- Beam Angle: 120°
- Rated life: 50,000 Hrs

### Applications:

- Integrated LED glass pendant is a contemporary and stylish design that can be used by itself as an accent piece, or grouped together to light a kitchen island, bar, or pool table.

## Other Models:

- 12W | 810LM | LCFH-1L-MCT5
- 36W | 2430LM | LCFH-3LS-MCT5



**Photometrics:** LCFH-3LR-MCT5

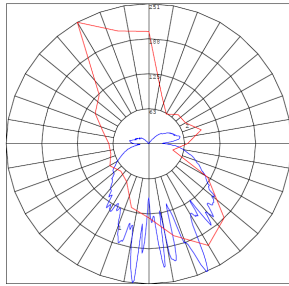
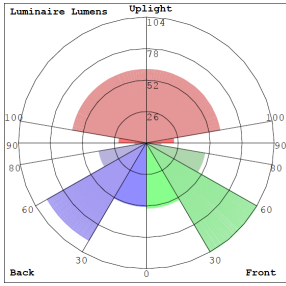

BUG Rating: B0-U3-G1

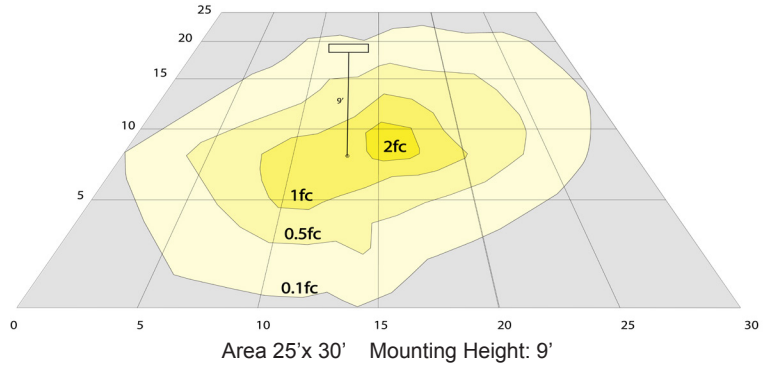

Area 25'x 30' Mounting Height: 9'

**Other Views:**



Side View



Glass Lens View

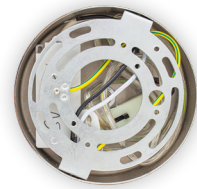

Top View

**Performance Table:** LCFH-3LR-MCT5

| MODEL NO.     | Wattage | Voltage | Lumens | Color Temp.                       | BUG Rating | LPW |
|---------------|---------|---------|--------|-----------------------------------|------------|-----|
| LCFH-3LR-MCT5 | 36W     | 120V    | 2430LM | 2700K/ 3000K/ 3500K/ 4000K/ 5000K | B1-U1-G0   | 68  |

**Sample Ordering**

**Model**      **Light**      **Color Temp.**

LCFH - 3LR - MCT5

**Example:**

1. LCFH-3LR-MCT5

(FOR LCFH 36W MCT5 FIXTURE 120V)

**Other Model:** LCFH-1L-MCT5



Side View



Glass Lens View

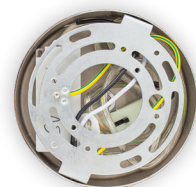

Top View

