

**JUNO**<sup>®</sup>

Project: \_\_\_\_\_

Fixture Type: \_\_\_\_\_

Location: \_\_\_\_\_

Contact/Phone: \_\_\_\_\_

**TRAC-MASTER**<sup>®</sup>Avant Garde  
**CYLINDRA™ 15W LED****T254L G2****PRODUCT DESCRIPTION**

The Cylindra™ 15W LED approximates the light output and distribution of 90W PAR30 halogen lamps in a PAR30 size fixture, utilizing approximately 1/6 of the energy and having a rated life of 50,000 hours. Available in 2700K, 3000K, 3500K and 4000K color temperatures with a minimum 80 CRI. Optional high CRI versions are available with a minimum 90 CRI and R9 greater than 50. There are also optional SpectralWhite color/white enhancing versions which offer minimum 90 CRI while rendering colors richly and making whites appear naturally brilliant. The contemporary styling of the Cylindra LED enables it to subtly enhance practically any decor without diverting attention from the surrounding environment. Soft curved surfaces combine with clean, crisp edges to provide a uniquely attractive aesthetic. Cylindra's integral, bayonet-mounted accessory holder accommodates up to two accessories if desired.

**Cylindra 15W LED**

**Construction** Die cast aluminum housing provides outstanding thermal management of LED, yielding 70% average lumen maintenance at 50,000 hours of operation • Fashionable, elegant design complements any decor • Available in white, black and silver painted finishes.

**LED** High performance LED array provides outstanding reliability, performance and color quality/ consistency • 2700K, 3000K, 3500K or 4000K white phosphor high performance LEDs • Chromaticity range within a 3-step MacAdam Ellipse • 80 CRI minimum on standard product • Optional high CRI versions offer 90 CRI minimum • Optional SpectralWhite color/white enhancing versions are available which make whites appear naturally brilliant and render colors more richly.

**Driver** Concealed in rear housing to minimize overall fixture footprint • Provides quiet operation with or without dimming • Dimmable using high quality, factory-approved reverse phase ELV dimmers – see [T254LG2-DIM](#) • Solid state electronic, Class 2 compliant • Integral overcurrent and short circuit protection • Designed for greater than 50,000 hour operating life • FCC Certified to Part 15 Class B EMI standards.

**Optics** Interchangeable computer-designed custom faceted reflectors available in three factory configured beam spreads • One reflector provided with fixture (as specified in catalog number) • Accessory reflectors available to enable beam changes in the field • Beam patterns can be altered as desired using a variety of available light control accessories.

**Juno Universal Trac Adapter** Universally compatible with both Trac-Master 1-circuit or 2-circuit trac, Trac-Lites trac, monopoints and special mountings

- Also UL Recognized for use on ConTech® LT Series track • Copper alloy contacts provide precise spring action - no arcing and will not take a set
- True, positive electrical ground • On/off switch included • Patented embossed polarity arrows on bottom of adapter • Spring-loaded positive latch with embossed polarity arrows secures trac fixture to trac • Two-position power contact provided for two-circuit application.

**Alternate TEK Trac Adapter** Compatible with Juno TEK trac system • System specific and assembled to trac fixture • Integrally polarized construction to prevent reverse installation – only allows insertion in proper orientation • Rotary circuit selector enables simple switching between circuits • Integral on/off switch enables individual fixtures to be switched for servicing.

**Alternate GTYPE Trac Adapter** Compatible with track systems based on GES type track, including Lithonia LT Commercial Track (not LTS type) • System specific and assembled to trac fixture • Consult factory for additional information.

**Alternate HTYPE Trac Adapter** Compatible with track systems which use a H-type track adapter, including Lithonia LTS Decorative Track (not LT type) • System specific and assembled to trac fixture • Two-position power contact provided for two-circuit application • Consult factory for additional information.

**Alternate LTYPE Trac Adapter** Compatible with track systems which use a L-type track adapter • System specific and assembled to trac fixture • Two-position power contact provided for two-circuit application • Consult factory for additional information.

**Accessory Holder** Integral to fixture design • Die cast aluminum construction • Precision bayonet mounting • Accommodates up to two accessories if desired.

**Aiming** 360° horizontal coverage • 105° vertical aiming capability.

**Labels** UL and C-UL Listed • ENERGY STAR® certified and DesignLights Consortium® Qualified • Union made • Assembled in U.S.A.

**Buy American** This product is assembled in the USA and meets the Buy America(n) government procurement requirements under FARS, DFARS and DOT. Please refer to [www.acuitybrands.com/buy-american](http://www.acuitybrands.com/buy-american) for additional information.

**Warranty** 5-year limited warranty. This is the only warranty provided and no other statements in this specification sheet create any warranty of any kind. All other express and implied warranties are disclaimed. Complete warranty terms located at: [www.acuitybrands.com/CustomResources/Terms\\_and\\_conditions.aspx](http://www.acuitybrands.com/CustomResources/Terms_and_conditions.aspx).

Specifications subject to change without notice.

ConTech is a registered trademark of ConTech Lighting.

# TRAC-MASTER®

Avant Garde  
**CYLINDRA™ 15W LED**  
**T254L G2**

## ORDERING INFORMATION

Ordering Example: T254L G2 27K 90CRI PDIM SP BL

Series	Mounting Adapter Type	Generation	Color Temperature	Color Rendering Index	Dimming Compatibility	Distribution	Finish
T254L 15W Cylindra LED	<b>(Blank)</b> Juno Universal Trac Adapter	G2 Gen 2	<b>27K</b> 2700K	<b>80CRI</b> 80 CRI <b>90CRI</b> 90 CRI <b>SPW<sup>3</sup></b> SpectralWhite	<b>PDIM</b> Phase Dimmable	<b>SP</b> Spot <b>NFL</b> Narrow Flood <b>FL</b> Flood	<b>BL</b> Black <b>SL</b> Silver <b>WH</b> White
	<b>TEK</b> TEK 120V Trac Adapter		<b>30K</b> 3000K				
	<b>GTYPE</b> G-Type Trac Adapter		<b>35K</b> 3500K				
	<b>HTYPE</b> H-Type Trac Adapter		<b>40K</b> 4000K				
	<b>LTYPE</b> L-Type Trac Adapter						

Accessories							
<b>HCLBL 375</b>	Hexcell Louver - Black	<b>TBDR BLCK 375</b>	Barn Doors - Black	<b>DIFF 375</b>	Diffusion Lens	<b>TR2 SPT</b>	Reflector – Spot
<b>CCLBL 375</b>	Cube Cell Louver - Black	<b>CGF 375</b>	Color Glass Filter	<b>SOLITE 375</b>	Uniformity Lens (Solite)	<b>TR2 NFLD</b>	Reflector – Narrow Flood
<b>XBAFLBL 375</b>	Cross Baffle - Black	<b>DGF 375</b>	Dichroic Glass Filter	<b>PRISM 375</b>	Prismatic Spread Lens	<b>TR2 FLD</b>	Reflector – Flood
<b>SNOOTBL 375</b>	Snoot - Black	<b>DCCF 375<sup>1</sup></b>	Dichroic Color Correction Filter	<b>LSPREAD 375</b>	Linear Spread Lens		
<b>EYEBROWBL 375</b>	Eyebrow - Black	<b>UVF 375</b>	UV Filter	<b>T40N<sup>2</sup></b>	Monopoint Canopy		

See specification sheet [D1.2.2](#) for details and color filter options.Other accessories can be found on specification sheet [D1.2.0](#).

## Notes:

- 1 DCCF 375 HAL2700 corrects 3000K color to approximately 2700K and 4000K color to approximately 3400K.
- 2 Add finish code to complete catalog number (Example: T40N WH).
- 3 3000K and 3500K only.

# TRAC-MASTER®

Avant Garde  
**CYLINDRA™ 15W LED**  
**T254L G2**

## DIMENSIONS

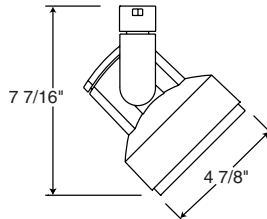

## PERFORMANCE DATA<sup>1</sup>

Catalog Number	Voltage	Input Watts (Typical)	Lumens	Efficacy (LPW)	Rated Life (Hours)
T254L G2 27K 80CRI SP	120V	15.2	1429	94	50,000
T254L G2 27K 80CRI NFL	120V	15.2	1477	97	50,000
T254L G2 27K 80CRI FL	120V	15.2	1504	99	50,000
T254L G2 27K 90CRI SP	120V	15.2	1164	77	50,000
T254L G2 27K 90CRI NFL	120V	15.2	1203	79	50,000
T254L G2 27K 90CRI FL	120V	15.2	1225	81	50,000
T254L G2 30K 80CRI SP	120V	15.2	1473	97	50,000
T254L G2 30K 80CRI NFL	120V	15.2	1523	100	50,000
T254L G2 30K 80CRI FL	120V	15.2	1551	102	50,000
T254L G2 30K 90CRI SP	120V	15.2	1208	79	50,000
T254L G2 30K 90CRI NFL	120V	15.2	1249	82	50,000
T254L G2 30K 90CRI FL	120V	15.2	1272	84	50,000
T254L G2 30K SPW SP	120V	15.2	1282	84	50,000
T254L G2 30K SPW NFL	120V	15.2	1325	87	50,000
T254L G2 30K SPW FL	120V	15.2	1349	89	50,000
T254L G2 35K 80CRI SP	120V	15.2	1517	100	50,000
T254L G2 35K 80CRI NFL	120V	15.2	1569	103	50,000
T254L G2 35K 80CRI FL	120V	15.2	1598	105	50,000
T254L G2 35K 90CRI SP	120V	15.2	1252	82	50,000
T254L G2 35K 90CRI NFL	120V	15.2	1295	85	50,000
T254L G2 35K 90CRI FL	120V	15.2	1318	87	50,000
T254L G2 35K SPW SP	120V	15.2	1311	86	50,000
T254L G2 35K SPW NFL	120V	15.2	1355	89	50,000
T254L G2 35K SPW FL	120V	15.2	1380	91	50,000
T254L G2 40K 80CRI SP	120V	15.2	1517	100	50,000
T254L G2 40K 80CRI NFL	120V	15.2	1569	103	50,000
T254L G2 40K 80CRI FL	120V	15.2	1598	105	50,000
T254L G2 40K 90CRI SP	120V	15.2	1282	84	50,000
T254L G2 40K 90CRI NFL	120V	15.2	1325	87	50,000
T254L G2 40K 90CRI FL	120V	15.2	1349	89	50,000

## ELECTRICAL DATA

Input Voltage	120V
Input Current (max.)	0.13A
Power Factor	>0.92

<sup>1</sup>Performance data, including Rated Life, is based on measurements of an individual fixture operating in a 25°C ambient.

# TRAC-MASTER®

Avant Garde  
**CYLINDRA™ 15W LED**  
**T254L G2**

**CBCP** • Centerbeam candlepower  
**FC** • Footcandles at beam center (aim point)

In vertical aiming applications, aim point (X) is determined by dividing distance from the wall (D) by the tangent of the desired aim angle (A) (0.5774 for 30°, 1.0 for 45°, 1.732 for 60°).

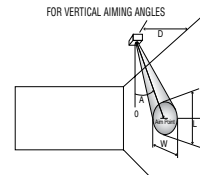
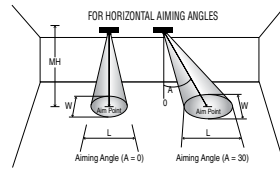

Lamp	Beam Type	Beam Spread°	Rated Life	CBCP	0°				30°			30°					45°				60°				
					MH	FC	L	W	FC	L	W	D	FC	X	L	W	FC	X	L	W	D	FC	X	L	W
<b>Cylindra 15W LED 3000K, 80CRI Spot</b>	SP	12°	50000	21510	10	215	2.0	2.0	140	2.7	2.3	4	168	6.9	3.3	1.6	475	4.0	1.6	1.1	8	218	4.6	2.2	1.9
					12	149	2.4	2.4	97	3.2	2.8	6	75	10.4	5.0	2.4	211	6.0	2.4	1.7	10	140	5.8	2.7	2.3
					14	110	2.8	2.8	71	3.8	3.3	8	42	13.9	6.6	3.2	119	8.0	3.3	2.3	12	97	6.9	3.2	2.8
					16	84	3.2	3.2	55	4.3	3.7	10	27	17.3	8.3	4.0	76	10.0	4.1	2.8	14	71	8.1	3.8	3.3
					18	66	3.6	3.6	43	4.8	4.2	12	19	20.8	10.0	4.8	53	12.0	4.9	3.4	16	55	9.2	4.3	3.7
<b>Cylindra 15W LED 3000K, 80CRI Narrow Flood</b>	NFL	24°	50000	5856	4	366	1.7	1.7	238	2.3	1.9	2	183	3.5	3.9	1.7	518	2.0	1.8	1.2	4	238	2.3	2.3	1.9
					6	163	2.5	2.5	106	3.4	2.9	3	81	5.2	5.8	2.5	230	3.0	2.6	1.8	5	152	2.9	2.8	2.4
					8	92	3.4	3.4	59	4.5	3.9	4	46	6.9	7.7	3.4	129	4.0	3.5	2.4	6	106	3.5	3.4	2.9
					10	59	4.2	4.2	38	5.7	4.8	5	29	8.7	9.7	4.2	83	5.0	4.4	3.0	7	78	4.0	4.0	3.4
					12	41	5.0	5.0	26	6.8	5.8	6	20	10.4	11.6	5.0	58	6.0	5.3	3.6	8	59	4.6	4.5	3.9
<b>Cylindra 15W LED 3000K, 80CRI Flood</b>	FL	44°	50000	2889	3	321	2.4	2.4	208	3.4	2.8	1	361	1.7	6.1	1.6	1021	1.0	1.9	1.1	3	208	1.7	3.4	2.8
					4	181	3.2	3.2	117	4.5	3.7	2	90	3.5	12.2	3.2	255	2.0	3.8	2.3	4	117	2.3	4.5	3.7
					5	116	4.0	4.0	75	5.6	4.6	3	40	5.2	18.3	4.8	113	3.0	5.7	3.4	5	75	2.9	5.6	4.6
					6	80	4.8	4.8	52	6.7	5.5	4	23	6.9	24.4	6.4	64	4.0	7.6	4.5	6	52	3.5	6.7	5.5
					7	59	5.6	5.6	38	7.9	6.4	5	14	8.7	**	8.0	41	5.0	9.5	5.6	7	38	4.0	7.9	6.4

For 27K 80CRI fixtures, use 0.97 multiplier; for 27K 90CRI fixtures, use 0.79 multiplier; for 30K 90CRI fixtures, use 0.82 multiplier; for 30K SPW fixtures, use 0.87 multiplier; for 35K 80CRI fixtures, use 1.03 multiplier; for 35K 90CRI fixtures, use 0.85 multiplier; for 35K SPW fixtures, use 0.89 multiplier; for 40K 80CRI fixtures, use 1.03 multiplier; for 40K 90CRI fixtures, use 0.87 multiplier.

\*\*Due to steep aiming angle, length of beam extends beyond 25'.