

CIRCLE-Line: Semi-Circle Up/Down Wall Pack

3-CCT + 3-Power Selectable



Detail Specifications

- Finish: Bronze, Custom finishes available
- IP Rating: Wet Location IP65
- Impact Rating: IK08
- Beam Angle: Type III (Standard)
- Chip: SMD 2835, R9 >50, CRI >80
- Wattage:
 - Up Light: 20W
 - Downlight: 80W
- BUG: B3-U2-G2
- Operating Temperature: -40° - 122° F
- Lens: Clear acrylic with optics
- Average life (L70) of 70,000 hours

Applications:

- Walkways & Pathways
- Parking Lots
- Hospitality, Multi-Family
- Outdoor Corridors
- Residential, Commercial and Industrial

Product Information:

- Sturdy die-cast aluminum housing finished with corrosion free powder coat
- Selectable light direction: up/down, down only/ up only
- Full Cut-Off Dark Sky Compliant With Uplight Off
- Photocell is included with an on/off switch
- Instant-On to full brightness
- Select-n-Switch Technology: 3-CCT + 3-Power Selectable

Driver Options:

- UNV: 120-277V 0-10V Dimmable
- Built in 6Kv Surge Protector
- THD: <20% (+/-5% tolerance), PF >0.9, 50/60Hz

Mounting & Installation:

- Mounts on to standard recessed junction box

Certifications:

- UL Listed for USA and CA
- DLC Listed
- ROHS Compliant
- Approved for CA T24
- 5 Year Limited Warranty
- FCC CFR 47, GCC Part 15, Subpart B:2017

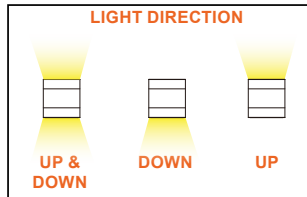

WATT	LUMENS
48	6,960
64	9,280
80	11,600

Series

LED-WPUD-SC-3P80-TRI

80/64/48W

Finish¹

- BZ**
Bronze (Standard)
- BL¹**
Black
- WH¹**
White
- GRY¹**
Gray
- CS¹**
Custom Color

1. Standard quickship is bronze. Other colors are made to order

Voltage

(blank)
120-277V

Photocell

-PC
Photocell is included. Easy quick disconnect. (PC-3/4-3PIN-LV)

Optic

- (blank)**
Type III
- T2**
Type II
- T4**
Type IV

Sensor²

- (blank)**
No Sensor
- BMS**
Bi-Level Motion + Daylight Sensor (S-BMS-EXT-1)
- BMSBT**
Bi-Level Motion + Daylight Sensor -Bluetooth Control- (S-BMS-EXT-1-BT)

2. Sensors require remote for programming

Emergency

- (blank)**
No Emergency
- EMB**
Emergency Backup

Surge Protector

- (blank)**
6KV Built in
- 20KV**
20KV Surge Protector

Optional Accessories (Order Separately)

Remote for Sensors

S-LINE-R
S-Line Remote

Specs and model numbers are subject to change with or without notice.

FEATURES

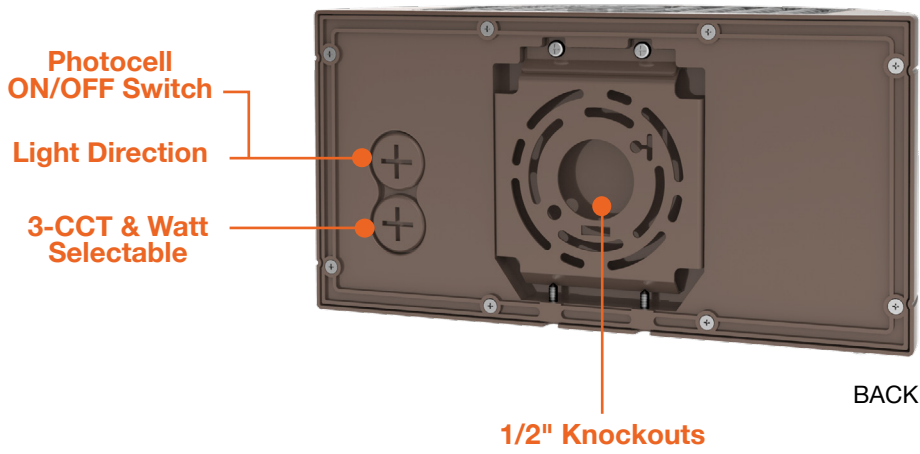
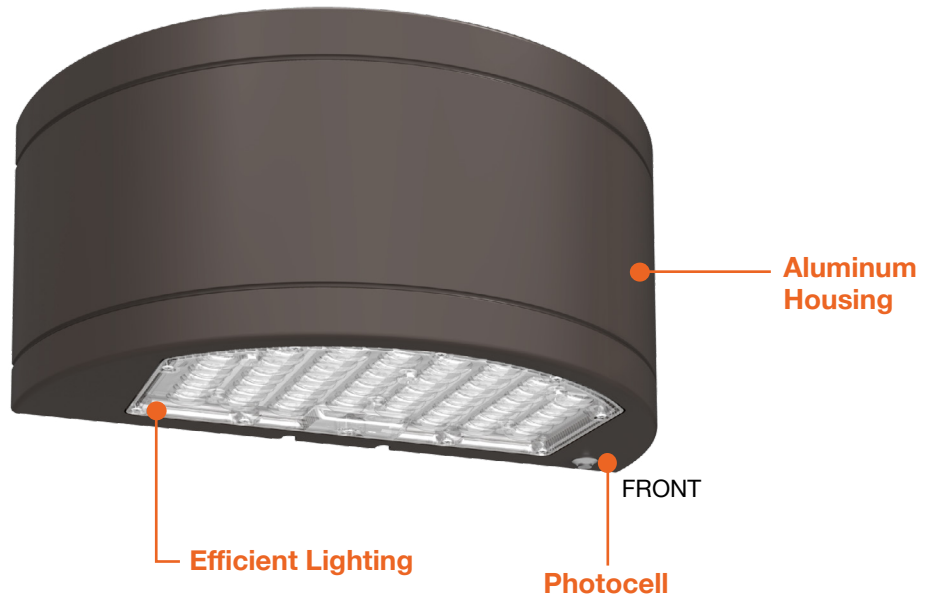
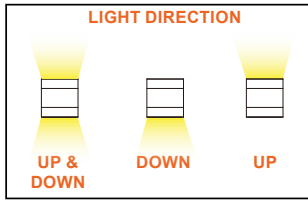

DIMENSIONS

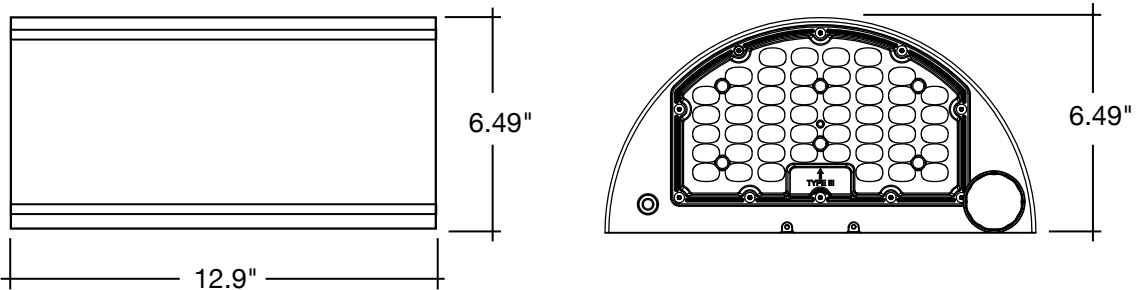

Specs and model numbers are subject to change with or without notice.



S-LINE-R



S-BMS-EXT-1
S-BMS-EXT-1-BT

WALL PACK

Model	Voltage	Watts	Lumens	Color	CRI
LED-WPUD-SC-3P80-TRI-BZ-PC	120-347V	80/64/48w	11,600/9,280/6,960	50/40/30k	>80

REMOTE CONTROL

Accessory Model	Description
S-LINE-R	Remote for S-LINE Series Sensors

HB-LINE-SENSORS

Model	Item Description	Voltage	Watts
S-BMS-EXT-1	S-Line: Bi Level Motion Sensor w/ Daylight Harvesting, Ideal for use with LED WALLPACKS. 12V Aux REQD. (Remote Required)	12V	<1w
S-BMS-EXT-1-BT	S-Line: Bi Level Motion Sensor w/ Daylight Harvesting, Ideal for use with Wallpacks. 12V Aux REQD. (Remote Required)	12V	<1w

Specs and model numbers are subject to change with or without notice.