

# 3" Koto™ Architectural Shallow Maximum Adjustability IC Airtight Housing



Koto™ Architectural Housing: 120/277V (0-10V/Triac/ELV) or 120V (Triac/ELV) with optional Emergency Battery Backup. Must be used with Koto™ Architectural LED Light Engines (ELK19 or ELK21 Series). Lumen output based on module.

## Features

- IC Airtight for direct contact with insulation.
- Easy-to-Remove driver.
- Optional 90 minutes, 120/277 VAC, 60Hz, Emergency Backup.
- Flicker-Free Dimming.
- USA designed and assembled.
- Limited 5 year warranty.
- For use with ELCO Koto™ Architectural LED Light Engines (ELK19 or ELK21 Series).

## Specifications

<b>Wattage</b>	14.7W
<b>Lumens</b>	850 (ELK19) - 1100 (ELK21) lm
<b>Voltage</b>	120/277V or 120V
<b>Dimmable</b>	Triac/ELV, 0-10V/Triac/ELV
<b>Lamp Type</b>	LED
<b>Power Factor</b>	≥0.95
<b>Damp Location</b>	Listed

## Technical Details

**Construction:** Single Wall IC Rated for direct contact with insulation. For use in IC and Non-IC conditions. Up to 1100 lumens. Housing adjusts in frame to accommodate up to 1 1/2" ceiling thickness. Airtight housing with gasket to restrict airflow in accordance with ASTM E-283 air-tight requirements.

**Installation:** Designed for ceiling plenums where 2x6 joists or taller are used. High strength hanger bars can easily be nailed to joists. Suitable for T-grid and drop ceiling applications. See installation sheet for detailed information. Emergency Battery Back-up Option requires access from above. For use with ELCO Koto™ Architectural LED Light Engines (ELK19 or ELK21 Series)

**Junction Box:** Positioned to accommodate straight conduit runs. Two 3/4" knockouts, Seven 1/2" trade size conduit knockouts, One 3/8" knockout. Four Pry-out knockout slots for easy romex installation.

**Hanger Bars:** Pre Installed hanger bars with True Nail easy installation in regular lumber, engineered lumber, and Laminated Beams. Integral T-bar slots for easy installation in T-Bars. Spans up 24" and can be repositioned 90°. Score lines allow for tool-free hanger bar size reduction. Integral leveling flange allows for single-person installation while easily aligning the housings with the joists.

**Electrical:** Driver is rated for 120V and 277V input (120/277V). High Efficiency driver with a power factor > 0.95.

**Emergency Battery Pack:** Optional 90 minute battery pack available with test indicator switch. Note that double wall housings require Access From Above Ceiling for Battery Maintenance.

**Dimmability:** 3-in-1 dimming: Triac, ELV and 0-10V dimming in one driver. 0-10V dimming down to 5% with a compatible dimmer. Can be specified with Lutron drivers for 0.1% and 1% dimming. For a full list of dimmers refer to the Dimmer Compatibility List.

**Listings:** UL Listed for Damp Location and for Wet Location with select trims. UL Listed for Direct Contact with Insulation and Combustible Material. UL Listed for Feed Through.

## E3LK76ICA Dimensions

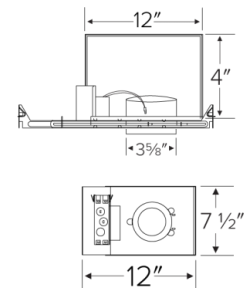

## E3LK77ICAD E3LK76ICA-S Dimensions

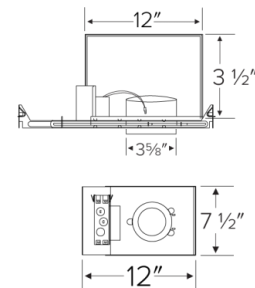

## Product Numbers

Item	Description	Lamp type	Lumens	Watts	Voltage	Dimming
E3LK76ICA	4" Shallow Maximum Adjustability Housing	LED	850 (ELK19) - 1100 (ELK21) lm	14.7W	120V	Triac/ELV
E3LK76ICA-S	3 1/2" Shallow Maximum Adjustability Housing	LED	850 (ELK19) - 1100 (ELK21) lm	14.7W	120V	Triac/ELV

Item	Description	Lamp type	Lumens	Watts	Voltage	Dimming
<b>E3LK771CAD</b>	3 1/2" Shallow Maximum Adjustability Housing	LED	850 (ELK19) - 1100 (ELK21) lm	14.7W	120/277V	0-10V/Triac/ELV

# Compatible Products

For use with Dedicated 3" Architectural ICA LED Housings



## Koto™ Architectural LED Light Engine

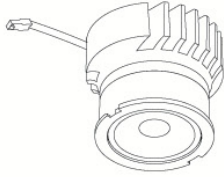

**Koto™ LED Light Engine**  
ELK21

PRODUCT NUMBER BUILDER			
Koto™ LED Light Engine	Lumens	Color Temperature	Beam Angle
ELK	21	27D 2700K 30D 3000K 35D 3500K 40D 4000K	(blank) 38° lens (Standard) -S 18° lens -N 25° lens -W 60° lens

ACCESSORIES	
<b>Lens</b>	<b>Reflectors</b>
EP731C 18° Lens	EP735C 15°
EP732C 25° Lens	EP736C 25°
EP733C 38° Lens	EP737C 38°
EP734C 60° Lens	EP738C 60°
<small>*EP732C, EP733C, EP734C Included</small>	
<b>Secondary Optics</b>	
L45 Hex Louver	
L46 Linear Louver	
L47 Spread Louver	

## 3" Pex™ Twist-&-Lock Trims

**Deep Reflector**  
ELK3618  
Finishes:  
(W, BB, BZ, B, C, H)

**Adjustable Gimbal**  
ELK3629  
Finishes:  
(W, BB, BZ, B, C, H)

**Adjustable Pinhole**  
ELK3627  
Finishes:  
(B, BB, BZ)

**Adjustable Baffle**  
ELK3693  
Finishes:  
(W)

**Slot Aperture**  
ELK3620  
Finishes:  
(W)

**Adj. Reflector Wall Wash**  
ELK3622  
Finishes:  
(W)

**Sq. Deep Reflector**  
ELK3318  
Finishes:  
(W, BB, BZ, B, C, H)

**Sq. Adjustable Gimbal**  
ELK3329  
Finishes:  
(W, BB, BZ, B, C, H)

**Sq. Adjustable Wall Wash**  
ELK3322  
Finishes:  
(W)

**Sq. Adjustable Baffle**  
ELK3393  
Finishes:  
(W)

**Sq. Adjustable Pinhole**  
ELK3327  
Finishes:  
(B, BB, BZ)

\*Finishes: **W** - All White, **BB** - All Black, **BZ** - All Bronze, **B** - Black Reflector w/White Ring, **C** - Chrome Reflector w/White Ring, **H** - Haze Reflector w/White Ring

