

# 3" Square Adjustable Pinhole

For use with MR16 lamps with GU5.3 Bi-Pin, GU10, or PSA37.



## Features

- 3" Square Adjustable Pinhole
- For use with MR16 lamps in 3" ELCO Housings
- 358° Rotation.
- 35° tilt
- Damp Location Rated.
- 4 3/8" Sq.

## Technical Details

**Construction:** Diecast aluminum with a powder coated finish.

**Installation:** Clips securely mount trim into housing and keeps ring flush with ceiling.

**Lamp:** Compatible with LED and non-LED GU5.3 BiPin, GU10 and PSA37.

### Compatible Housings:

- 3" Dedicated LED with PSA37: EL390ICA, EL390ICA-7, EL390RICA
- 3" LED Bi-Pin Low Voltage MR16 Housings with LED MR16 Bi-Pin GU5.3 Lamp: EL2699LDICA, EL2699LDICEA, EL2699LDRICA, EL2699LDRICEA
- 3" Bi-Pin Low Voltage MR16 Housings with MR16 Bi-Pin GU5.3 Lamp: EL2699ICA, EL2699ICEA, EL2699ICAS, EL2699A, EL2699EA, EL2699-277A, EL2699RA, EL2699REA, EL2699S, EL2699ES, EL2699RS, EL2699RES
- 3" LED MR16 GU10 Housings for Use with GU10 LED Lamp: EL39LDICA, EL39LDICA-7, EL39LDRICA
- 3" MR16 GU10 Housings for use with GU10 MR16 Lamp: EL39ICA, EL39A, EL39RA

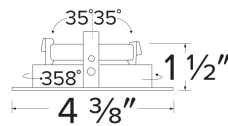
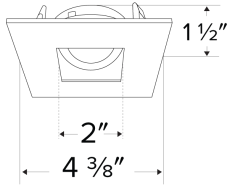

**Dimensions:**

## Options



**Black with White Trim**



**All Black**

## Product Numbers

Item	Finish
EL33MR27B	Black with White Trim
EL33MR27BB	All Black

## Product Number Builder Example: EL33MR27B

3" Square Adjustable Pinhole

Finish

**EL33MR27**

**B** Black with White Trim

**BB** All Black