

SPECIFICATION SHEET

JOB NAME: _____
 LOCATION: _____
 QUOTE/REF#: _____

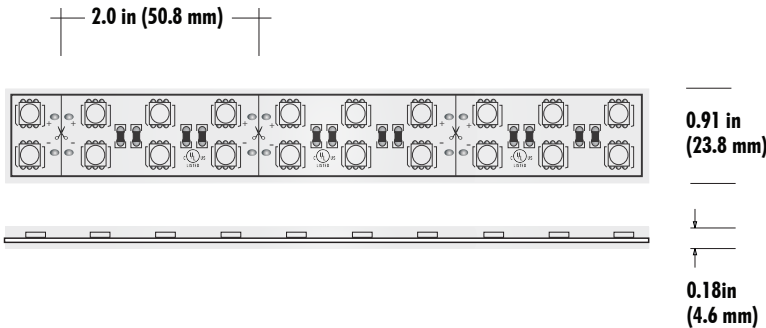

LSPW80-RGB super High Output color changing LED strip is designed to produce more than 720 lumens at 8.8 Watts per foot. It is an outdoor strip that provides a full spectrum of color options using red, green and blue LED technology. This LED strip is offered in a low profile design that can be attached almost anywhere and are great for many common lighting applications, such as cove lighting or cabinets. LSP-80 series produces a 160° light beam spread and is offered in different color temperatures to fit your specific needs. UL listed.

SPECIFICATIONS

INPUT VOLTAGE	24V DC
POWER CONSUMPTION	8.8W per foot
LUMEN OUTPUT	720 lm
NO. OF LEDs	36 LEDs per foot
BEAM ANGLE	120°
CRI	90+
DIMMING	Through RGB controller
MAXIMUM RUN LENGTH	20 feet
FIELD CUTTABLE	Every 2.0" (50.8MM)
IP RATING	IP65 wet location (outdoor)
LUMEN MAINTENANCE	50,000 hrs.
OPERATING TEMPERATURE	-40°F(-40°C)~+140°F(+60°C)
BINNING	1.5 Step Macadam Elipse
CERTIFICATIONS	UL listed, TITLE 24 JA8
DIMENSIONS	0.91" x 0.18 (width x height)

FEATURES

- 8.8W per Foot
- 720 Lumens
- 95+ CRI
- California **TITLE 24 JA8** compliant
- Field cuttable
- Suitable for accent or ambient lighting
- IP65 outdoor wet rated
- Superior COLOR RENDERING INDEX (CRI)
- Available in 24V
- UL Listed
- Dimmable with **CORE Lighting** dimmable drivers

SPECIFICATIONS

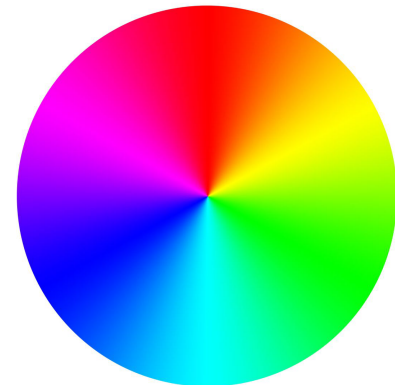

LSPW80-RGB 8.8W Outdoor Color-Changing LED Strip



STANDARD ORDERING CODE

Model	Color Temp	Length	Voltage
LSPW-80	RGB - RGB	16 - 16.4 Ft. 32 - 32 Ft. PF - Per foot	24V - 24V DC

CUSTOMIZED LENGTH ORDERING CODE

Model	Color Temp	Length	Voltage	Profile
LSPW-80	RGB - RGB	XX - Custom Length	24V - 24V DC	See p3

COMPATIBLE ALUMINUM PROFILES

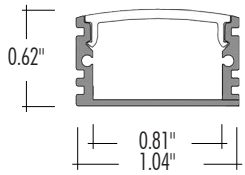

ALU-DS100 | SURFACE MOUNT
LENGTHS 39 ³/₈" and 78 ⁷/₈"
LENS Clear & Frosted
FINISH Anodized Aluminum

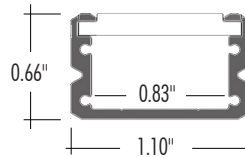

ALP-90 | SURFACE MOUNT
LENGTHS 48" and 96"
LENS Frosted
FINISH Anodized Aluminum

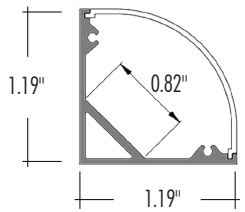

ALP-100C | SURFACE / CORNER MOUNT
LENGTHS 49.25" and 98.5"
LENS Frosted
FINISH Anodized Aluminum

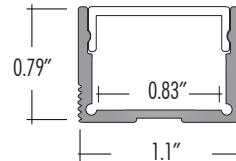

ALP-130 | SURFACE / SUSPENSION MOUNT
LENGTHS 49.25" and 98.5"
LENS Frosted
FINISH Anodized Aluminum

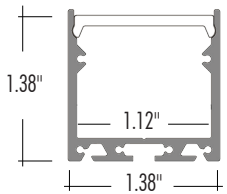

ALP-140 | SURFACE / SUSPENSION MOUNT
LENGTHS 49.25" and 98.5"
LENS Frosted
FINISH Anodized Aluminum

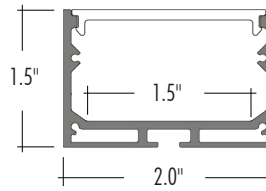

ALP-160 | SURFACE / SUSPENSION MOUNT
LENGTHS 49.25" and 98.5"
LENS Frosted
FINISH Anodized Aluminum

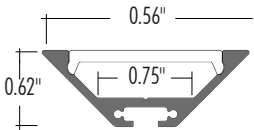

ALP-190 | SURFACE / SUSPENSION MOUNT
LENGTHS 49.25" and 98.5"
LENS Frosted
FINISH Anodized Aluminum

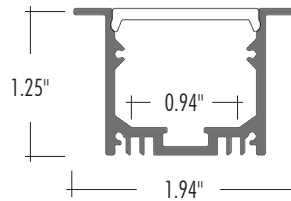

ALP-200R | RECESSED MOUNT
LENGTHS 49.25" and 98.5"
LENS Frosted
FINISH Anodized Aluminum

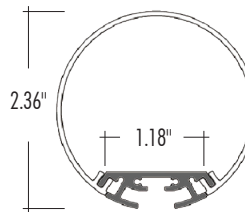

ALP-245 | SUSPENSION MOUNT
LENGTHS 49.25" and 98.5"
LENS Frosted
FINISH Anodized Aluminum

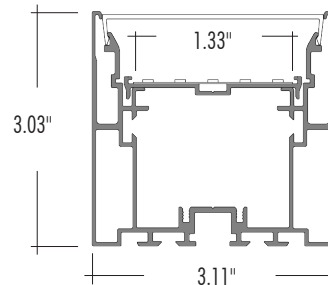

ALP-310N | SURFACE / SUSPENSION MOUNT
LENGTHS 49.25" and 98.5"
LENS Frosted
FINISH Anodized Aluminum

LSPW80-RGB 8.8W Outdoor Color-Changing LED Strip

COMPATIBLE TOUCH SERIES CONTROLLERS

RGB-CT330

**RECEIVING CONTROLLER
INPUT
MAX OUTPUT CURRENT
MAX OUTPUT POWER
WORKING TEMP
WEIGHT (gross)**

12V - 24V DC
3A X 3CH
108W(12V), 216W (24V)
-30°C ~ 55°C
135g

RECEIVER

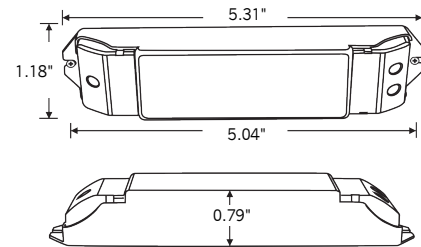

**HANDHELD REMOTE
INPUT VOLTAGE
WORKING FREQUENCY
REMOTE DISTANCE
WORKING TEMP
WEIGHT (gross)**

3V (CR2032 battery)
433.92MHz
90ft.
-30°C ~ 55°C
42g

HANDHELD REMOTE

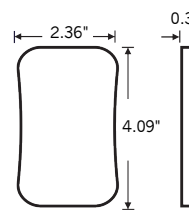

REMOTE CRADLE

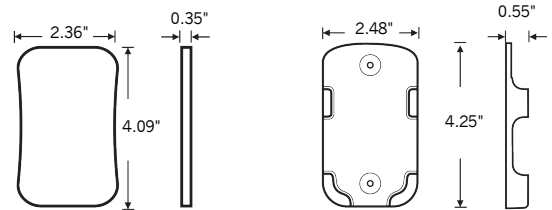

RGB-CT400

**RECEIVING CONTROLLER
INPUT
MAX OUTPUT CURRENT
MAX OUTPUT POWER
CONTROL BUTTON
WORKING TEMP
WEIGHT (gross)**

12V - 24V DC
5A X 3CH, 15A Max
180W(12V), 360W (24V)
8 touch button
-30°C ~ 55°C
180g

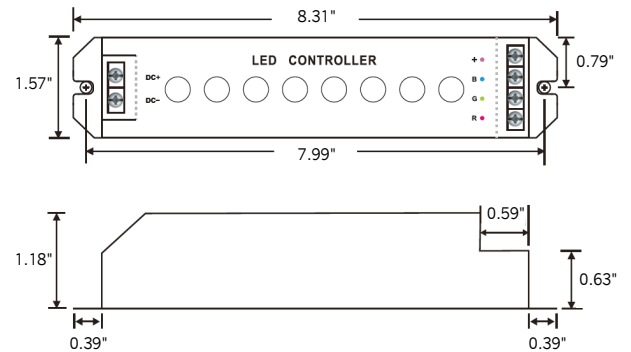

**RGB-CT400RX
(SOLD SEPARATELY)**

**HANDHELD REMOTE
INPUT VOLTAGE
WORKING CURRENT
WORKING FREQUENCY
REMOTE DISTANCE
CHANGE MODE
WEIGHT (gross)**

5V DC (Built-in Lithium battery)
< 30mA
2.4GHz
90ft.
32 modes
200g

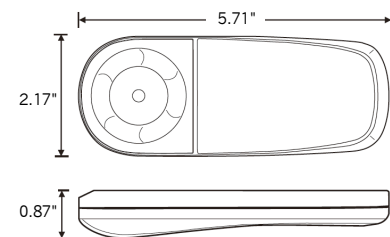

HANDHELD REMOTE

COMPATIBLE WALL CONTROLLERS

RGB-CT600 **INPUT VOLTAGE** 5V DC, 1A
OUTPUT SIGNAL RF 2.4GHz + DMX512
CONTROL 4 ZONES
WORKING TEMP -30°C ~ 55°C
WEIGHT (gross) 370g



RGB-SDE3 **INPUT POWER** 6V DC 0.6A
OUTPUT SIGNAL DMX512 (x2)
PROGRAMMABILITY PC, MAC,
 Tablet, Smartphone
AVAILABLE COLORS Black / White
CONNECTIONS USB, Ethernet, RS232,
 Clock, 8dry contact ports,
 5V output relay
MEMORY microSD card
WORKING TEMP -10°C ~ 45°C
MOUNTING Single or double gang wall socket
WEIGHT (gross) 247g

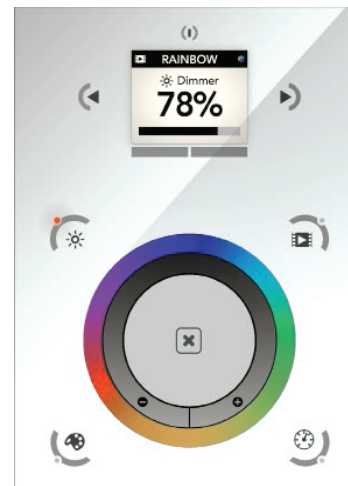

LSPW80-RGB 8.8W Outdoor Color-Changing LED Strip

COMPATIBLE DMX RECEIVERS

RGB-DMX4C-RJ45

4 Channel RGB DMX Decoder

INPUT	12V - 36V DC
OUTPUT CURRENT	5A X 4CH
OUTPUT POWER	60W(12V), 120W (24V)
OUTPUT CHANNELS	3 or 4 selectable
DIMENSIONS	L x W x H (178mm x 45mm x 19mm)



COMPATIBLE NON-DIMMING TRANSFORMERS

PSHW SERIES 24V

	CLASS 2	L X W X H
PSHW-10W-24V	YES	2.55" X 1.37" X .90"
PSHW-20W-24V	YES	4.64" X 1.38" X 1.2"
PSHW-35W-24V	YES	5.83" X 1.57" X 1.18"
PSHW-60W-24V	YES	6.38" X 1.65" X 1.18"
PSHW-100W-24V	NO	7.44" X 2.4" X 1.45"
PSHW-150W-24V	NO	8.75" X 2.68" X 1.53"
PSHW-200W-24V	NO	9.62" X 2.68" X 1.53"
PSHW-300W-24V	NO	9.92" X 3.55" X 1.75"



PSHK SERIES

	CLASS 2	L X W X H
PSHK-30W-24V-UNV	YES	6.5" X 3.6" X 1.02"
PSHK-60W-24V-UNV	YES	7.4" X 3.6" X 1.02"
PSHK-96W-24V-UNV	YES	8.66" X 3.6" X 1.61"
PSHK-150W-24V-UNV	YES	10.24" X 4.06" X 1.81"
PSHK-200W-24V-UNV	NO	10.24" X 4.06" X 1.81"
PSHK-300W-24V-UNV	NO	10.94" X 4.25" X 1.81"

