

LSPW52-RGBW 4.4W Outdoor Color-Changing LED Strip

JOB NAME: _____
LOCATION: _____
QUOTE/REF#: _____



LSPW52-RGBW series is a flexible color-changing LED strip that provides the perfect lighting solution for spaces that require dynamic full color and white LED illumination. The warm white LED's combined with the full color spectrum of the RGBW light array produces more powerful color options that's sure to please even the most discerning lighting designer. Suitable for residential, commercial, hospitality and architectural lighting applications.

SPECIFICATIONS

INPUT VOLTAGE	24V DC
POWER CONSUMPTION	4.4W per Ft.
LUMEN OUTPUT	287 lm per Ft.
NO. OF LEDs	60 LEDs per Ft.
BEAM ANGLE	120°
CRI	90+
DIMMING	Through RGBW controller
MAXIMUM RUN LENGTH	20 feet
FIELD CUTTABLE	Every 2.46" (62.5MM)
IP RATING	Outdoor, wet location (indoor)
LUMEN MAINTENANCE	50,000 hrs.
OPERATING TEMPERATURE	-40°F(-40°C)~+140°F(+60°C)
STORAGE TEMPERATURE	-40°F(-40°C)~+140°F(+60°C)
CERTIFICATIONS	UL listed, TITLE 24 JA8
DIMENSIONS	0.49" x 0.20" (width x height)

FEATURES

- 4.4W per Foot
- 287 Lumens
- 27K / 30K / 40K White CCT
- 90 CRI
- California TITLE 24 JA8 compliant
- Field cuttable
- Suitable for accent or ambient lighting
- Outdoor, wet rated
- Superior COLOR RENDERING INDEX (CRI)
- Available in 24V
- UL Listed

DIMENSIONS

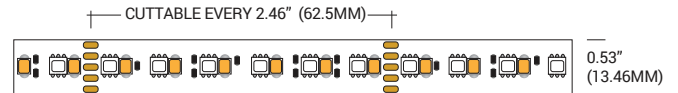

LSPW52-RGBW 4.4W Outdoor Color-Changing LED Strip

STANDARD ORDERING CODE

MODEL	COLOR TEMPERATURE	LENGTH	VOLTAGE
LSPW-52	RGBW27K RGB + 2700K	16 16 Feet	24V 24V DC
	RGBW30K RGB + 3000K	32 32 Feet	
	RGBW40K RGB + 4000K	PF Per foot	

LSPW52-RGBW 4.4W Outdoor Color-Changing LED Strip

COMPATIBLE ALUMINUM PROFILES

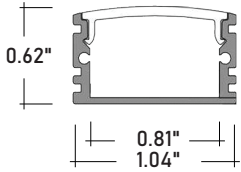

ALU-DS100 **SURFACE MOUNT**
LENGTHS 39^{3/8}" 78"
LENS Clear and Frosted
FINISH Anodized Aluminum

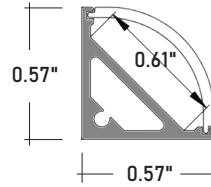

ALP-50C **SURFACE / CORNER**
LENGTHS 49.25" , 98.5"
LENS Frosted
FINISH Anodized Aluminum

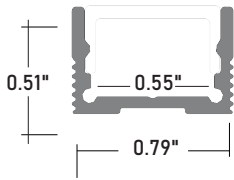

ALP-70 **SURFACE MOUNT**
LENGTHS 49.25" , 98.5"
LENS Frosted
FINISH Anodized Aluminum

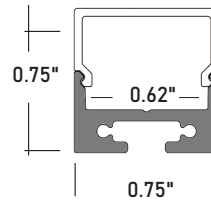

ALP-80 **SURFACE / SUSPENDED**
LENGTHS 49.25" , 98.5"
LENS Frosted
FINISH Anodized Aluminum

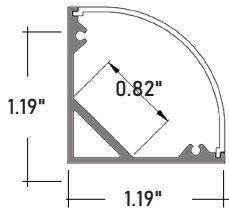

ALP-100C **SURFACE / CORNER**
LENGTHS 49.25" and 98.5"
LENS Frosted
FINISH Anodized Aluminum

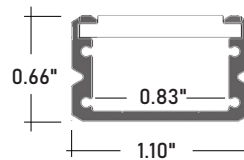

ALP-90 **SURFACE MOUNT**
LENGTHS 48" and 96"
LENS Frosted
FINISH Anodized Aluminum

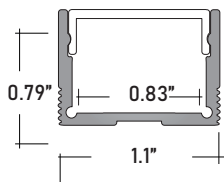

ALP-130 **SURFACE / SUSPENDED**
LENGTHS 49.25" and 98.5"
LENS Frosted
FINISH Anodized Aluminum

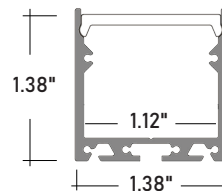

ALP-140 **SURFACE / SUSPENDED**
LENGTHS 49.25" and 98.5"
LENS Frosted
FINISH Anodized Aluminum

LSPW52-RGBW 4.4W Outdoor Color-Changing LED Strip

COMPATIBLE WALL CONTROLLERS

RGB-CT600	INPUT VOLTAGE	5V DC, 1A
	OUTPUT SIGNAL	RF 2.4GHz + DMX512
	CONTROL	4 ZONES
	WORKING TEMP	-30°C ~ 55°C
	WEIGHT (gross)	370g



RGB-SDE3	INPUT POWER	6V DC 0.6A
	OUTPUT SIGNAL	DMX512 (x2)
	PROGRAMMABILITY	PC, MAC, Tablet, Smartphone
	AVAILABLE COLORS	Black / White
	CONNECTIONS	USB, Ethernet, RS232, Clock, 8dry contact ports, 5V output relay
	MEMORY	microSD card
	WORKING TEMP	-10°C ~ 45°C
	MOUNTING	Single or double gang wall socket
	WEIGHT (gross)	247g

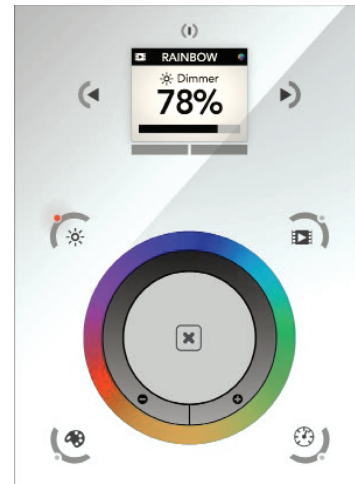

LSPW52-RGBW 4.4W Outdoor Color-Changing LED Strip

COMPATIBLE DMX RECEIVERS

RGB-DMX4C-RJ45

4 Channel RGB DMX Decoder

INPUT

12V - 36V DC

OUTPUT CURRENT

5A X 4CH

OUTPUT POWER

60W(12V), 120W (24V)

OUTPUT CHANNELS

3 or 4 selectable

DIMENSIONS

L x W x H (178mm x 45mm x 19mm)



LSPW52-RGBW 4.4W Outdoor Color-Changing LED Strip

COMPATIBLE NON-DIMMING TRANSFORMERS

PSHW SERIES 24V

PSHW SERIES	CLASS 2	L X W X H
PSHW-10W-24V	YES	2.55" X 1.37" X .90"
PSHW-20W-24V	YES	4.64" X 1.38" X 1.2"
PSHW-35W-24V	YES	5.83" X 1.57" X 1.18"
PSHW-60W-24V	YES	6.38" X 1.65" X 1.18"
PSHW-100W-24V	NO	7.44" X 2.4" X 1.45"
PSHW-150W-24V	NO	8.75" X 2.68" X 1.53"
PSHW-200W-24V	NO	9.62" X 2.68" X 1.53"
PSHW-300W-24V	NO	9.92" X 3.55" X 1.75"



PSHK SERIES

PSHK SERIES	CLASS 2	L X W X H
PSHK-30W-24V-UNV	YES	6.5" X 3.6" X 1.02"
PSHK-60W-24V-UNV	YES	7.4" X 3.6" X 1.02"
PSHK-96W-24V-UNV	YES	8.66" X 3.6" X 1.61"
PSHK-150W-24V-UNV	YES	10.24" X 4.06" X 1.81"
PSHK-200W-24V-UNV	NO	10.24" X 4.06" X 1.81"
PSHK-300W-24V-UNV	NO	10.94" X 4.25" X 1.81"

