

LSP50RGBW

4.4W Indoor Color-Changing + White LED Strip

CORE
ARCHITECTURAL
LIGHTING

JOB NAME: _____
LOCATION: _____
QUOTE/REF#: _____



LSP50RGBW is a color changing flexible LED strip that provides a full spectrum of color options using red, green blue and white LED technology. The countless color mixing possibilities make RGB LEDs a diverse choice for even the most critical in lighting solutions and applications. It can be easily installed onto most surfaces with its attached double-sided mounting tape.

SPECIFICATIONS

INPUT VOLTAGE	24V DC
IP RATING	IP54 Indoor rated
CCT	RGBW
CRI	90+
WATTAGE	4.4W/FT
LUMENS	287Lm/FT
MAX RUN	25FT
CUTTING	8"
DIMMING	Through RGBW Controller
BEAM ANGLE	120°
OPERATING TEMP	5°C (41°F) to 70°C (158°F)
AMBIENT TEMP	-20°C (4°F) to 40°C (108°F)
RATING	UL listed, Dry location
LUMEN MAINTENANCE	50,000 Hrs.

FEATURES

- Full range RGB + White
- Designed for easy installation
- Fully compatible with DMX systems
- Indoor (dry) location rated
- UP to 25 FT continuous run
- California TITLE 24 JA8 compliant
- Field cuttable
- Suitable for accent or ambient lighting
- Multiple CCT options available
- Superior COLOR RENDERING INDEX (CRI)

RGBW COLOR SPECTRUM



LSP50RGBW

4.4W Indoor Color-Changing + White LED Strip

STANDARD ORDERING CODE

EX:
LSP50-RGBW30K-16-24-ALP70

Model	Color Temperature	Length	Voltage	Profile
LSP50	RGBW27K RGBW + 2700K	16 16.4 Ft.	24 24 Volts	²See p3 for options
	RGBW30K RGBW + 3000K	100 100 Ft.		
	RGBW50K RGBW + 5000K	¹XX per Ft.		

NOTE:

- 1** = Custom length per Ft.
Cuttable every 8"
- 2** = Custom color finishes require powder coating. Allow 7 days lead time.

LSP50RGBW

4.4W Indoor Color-Changing + White LED Strip

COMPATIBLE ALUMINUM PROFILES

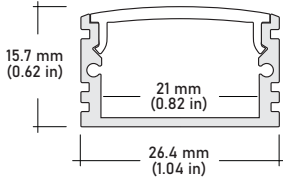

ALU-DS100 Surface Wide
LENGTHS 39^{3/8"} | 78^{7/8"} | 96"
LENS Clear, Frosted
FINISH Silver

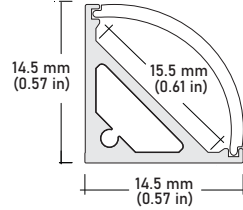

ALP-50C Surface, Corner
LENGTHS 49.25" | 98.5"
LENS Frosted
FINISH White | Black | Silver

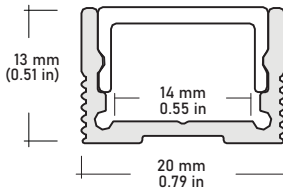

ALP-70 Surface
LENGTHS 49.25" | 98.5"
LENS Frosted
FINISH White | Black | Silver

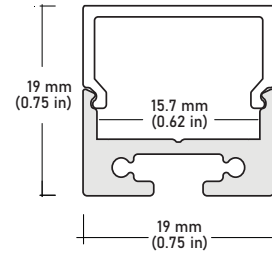

ALP-80 Surface, Suspended
LENGTHS 49.25" | 98.5"
LENS Frosted
FINISH Silver

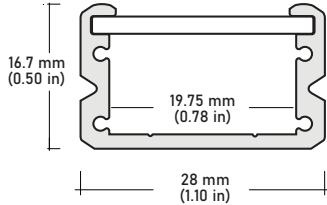

ALP-90 Surface
LENGTHS 48" | 96"
LENS Frosted
FINISH Silver

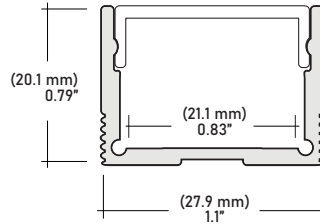

ALP-130 Surface, Suspended
LENGTHS 49.25" | 98.5"
LENS Frosted
FINISH Silver

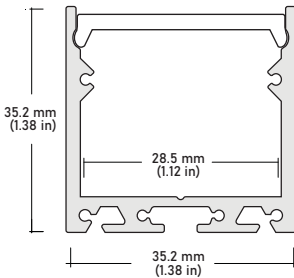

ALP-140 Surface, Suspended
LENGTHS 49.25" | 98.5"
LENS Frosted
FINISH Silver

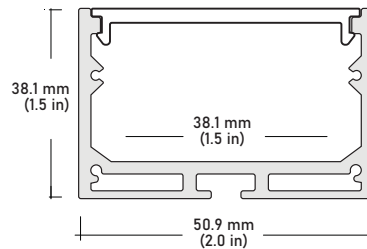

ALP-160 Surface, Suspended
LENGTHS 48" | 98"
LENS Frosted
FINISH Silver

LSP50RGBW

4.4W Indoor Color-Changing + White LED Strip

COMPATIBLE WALL CONTROLLERS



RGB-CT600 MULTI-FUNCTION RGBW WALL CONTROLLER

INPUT VOLTAGE	5V DC, 1A
OUTPUT SIGNAL	RF 2.4GHz + DMX512
CONTROL	4 ZONES
WORKING TEMP	-20°C ~ 40°C
DIMENSIONS	LxWxH (5.19"x 7.08"x 1.38")



RGB-SDE3 MULTI-FUNCTION RGBW WALL CONTROLLER

INPUT POWER	6V DC 0.6A
OUTPUT SIGNAL	DMX512 (x2)
PROGRAMMABILITY	PC, MAC, Tablet, Smartphone
AVAILABLE COLORS	Black / White
CONNECTIONS	USB, Ethernet, RS232, Clock, 8dry contact ports, 5V output relay
MEMORY	microSD card
WORKING TEMP	-10°C ~ 45°C
WEIGHT (gross)	247g
DIMENSIONS	LxWxH (5.75"x 4.17"x 0.43")

LSP50RGBW

4.4W Indoor Color-Changing + White LED Strip

COMPATIBLE DMX RECEIVERS

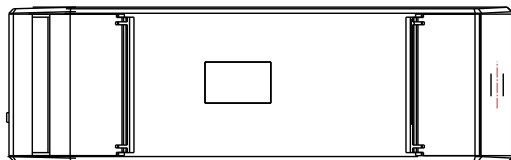

RGB-DMX-4C-RJ45 4 CHANNEL DMX DECODER

INPUT	12V - 24V DC
OUTPUT CURRENT	8A X 4CH
OUTPUT POWER	240W(12V), 720W (24V)
OUTPUT CHANNELS	3 or 4 selectable
DIMENSIONS	LxWxH (7"x 1.77"x 0.75")

LSP50RGBW

4.4W Indoor Color-Changing + White LED Strip

COMPATIBLE NON-DIMMING TRANSFORMERS



PSHW SERIES NON-DIMMING CONSTANT VOLTAGE

PSHW-10W-24V	CLASS 2	2.55" X 1.37" X .90"
PSHW-20W-24V	CLASS 2	4.64" X 1.38" X 1.2"
PSHW-35W-24V	CLASS 2	5.83" X 1.57" X 1.18"
PSHW-60W-24V	CLASS 2	6.38" X 1.65" X 1.18"
PSHW-100W-24V		7.44" X 2.4" X 1.45"
PSHW-150W-24V		8.75" X 2.68" X 1.53"
PSHW-200W-24V		9.62" X 2.68" X 1.53"
PSHW-300W-24V		9.92" X 3.55" X 1.75"

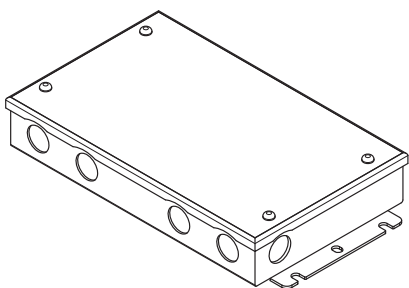

PSHK SERIES NON-DIMMING WITH JUNCTION BOX

PSHK-30W-24V-UNV	CLASS 2	6.5" X 3.6" X 1.02"
PSHK-60W-24V-UNV	CLASS 2	7.4" X 3.62" X 1.02"
PSHK-96W-24V-UNV	CLASS 2	8.66" X 3.66" X 1.61"
PSHK-150W-24V-UNV		10.24" X 4.06" X 1.81"
PSHK-200W-24V-UNV		10.24" X 4.06" X 1.81"
PSHK-300W-24V-UNV		10.94" X 4.25" X 1.81"