

LSP-50 RGB

4.4W INDOOR COLOR-CHANGING LED STRIP

Project _____
Location _____
Quote/ Ref # _____

LSP-50 RGB is a color-changing flexible LED strip that provides a full spectrum of color options using red, green and blue LED technology. The countless color mixing possibilities make RGB LEDs a diverse choice for even the most discerning in lighting solutions and applications. It can be easily installed onto most surfaces with double sided mounting tapes.

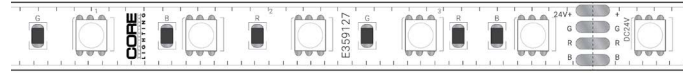

SPECIFICATIONS

INPUT VOLTAGE	12V 24V DC
POWER CONSUMPTION	4.4W/ Ft.
LUMEN OUTPUT	165 Lm/Ft.
COLOR TEMPERATURE	RGB
DIMMING	Through RGB Controller
MAXIMUM RUN LENGTH	20 Ft. (12V) 30 Ft. (24V)
CUTTABLE	Every 2in (50.1mm) (12V) Every 4in (101.6mm) (24V)
OPERATING TEMPERATURE	41°F (5°C) to 158°F (70°C)
AMBIENT TEMPERATURE	4°F (-20°C) to 108°F (40°C)
BEAM ANGLE	120°
IP RATING	IP54 (Indoor)
CERTIFICATIONS	UL Listed
LUMEN MAINTENANCE	50,000 Hrs.

FEATURES

- Full range RGB
- Designed for easy installation
- Indoor (Dry Location) Rated
- 20 Ft. (12V) | 30 Ft. (24V) Max Run
- Field Cuttable
- Superior Color Rendering Index (CRI)
- UL Listed



MODEL	COLOR TEMP	LENGTH	VOLTAGE	PROFILE
LSP-50	RGB RGB Color-Changing	16 16 Ft.	12 12V	See Page 2 for compatible profiles.
		100 100 Ft.	24 24V DC	
		*1 Per Ft.		

*1 = Custom length per FT.
(12V Strip cuttable every 2")
(24V Strip cuttable every 4")

*Custom color finishes require powder coating. Allow 7 days leads time.

LSP-50 RGB

4.4W INDOOR COLOR-CHANGING LED STRIP

DIMENSIONS

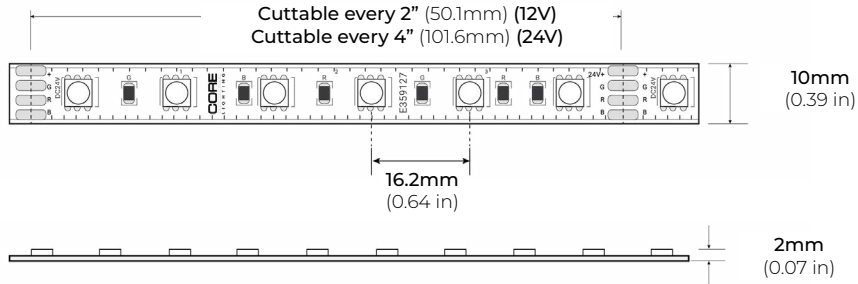

COMPATIBLE ALUMINUM PROFILES

SURFACE PROFILES

ALU-SF

LENGTHS 39" | 78" | 84" | 98"
LENS Clear, Frosted
FINISH Black | Silver

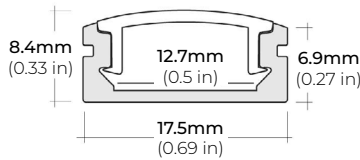

ALU-CN (CORNER)

LENGTHS 39" | 78" | 84" | 96"
LENS Clear, Frosted
FINISH Black | Silver

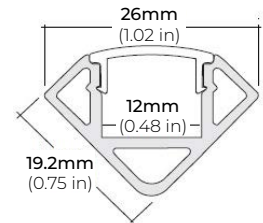

ALU-DS100

LENGTHS 39" | 78" | 84"
LENS Clear, Frosted
FINISH Silver

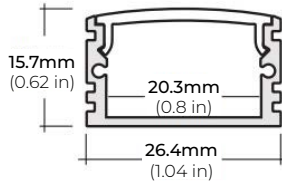

ALP-20

LENGTHS 49" | 84" | 98"
LENS Frosted
FINISH White | Black | Silver

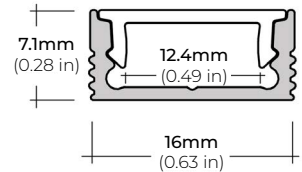

ALP-50C (CORNER)

LENGTHS 48" | 84" | 98"
LENS Frosted
FINISH Silver

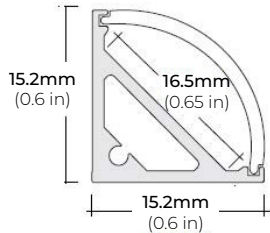

ALP-60

LENGTHS 49" | 84" | 98"
LENS Frosted
FINISH White | Black | Silver

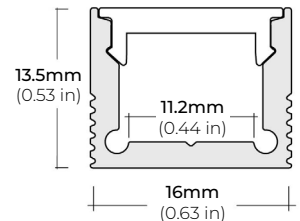

ALP-70

LENGTHS 49" | 84" | 98"
LENS Frosted
FINISH White | Black | Silver

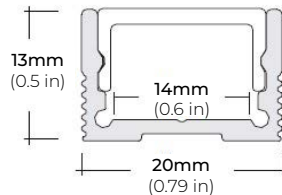

ALP-80

LENGTHS 49" | 98"
LENS Frosted
FINISH Silver

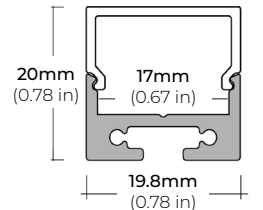

* For more compatible profiles, visit corelightingusa.com

RECESSED PROFILES

ALP-20R

LENGTHS 49" | 98"
LENS Frosted
FINISH White | Black | Silver

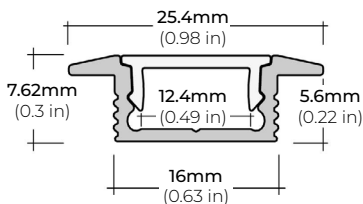

ALP-60R

LENGTHS 49" | 84" | 98"
LENS Frosted
FINISH White | Black | Silver

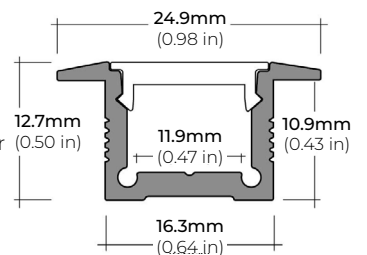

* For more compatible profiles, visit corelightingusa.com

LSP-50 RGB

4.4W INDOOR COLOR-CHANGING LED STRIP

DMX CONTROLLERS

RGB CT600 MULTI-FUNCTION RGBW WALL CONTROLLER

INPUT VOLTAGE	5V DC, 1A
OUTPUT SIGNAL	RF 2.4GHZ + DMX512
CONTROL	4 ZONES
COLOR OPTIONS	Black/ White
WORKING TEMP	-20°C ~ 40°C
DIMENSIONS	LxWxH (5.19"x7.08"x1.38")

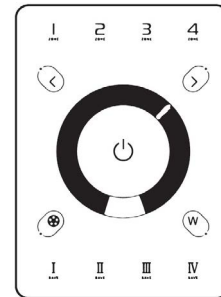

RGB-SCW4 WiFi DMX WALL CONTROLLER

INPUT VOLTAGE	5 - 10V DC, 06A
OUTPUT SIGNAL	DMX512 (x2)
PROGRAMMABILITY	PC/ MAC
COLOR OPTIONS	Black/ White
CONNECTIONS	USB/ 8dry contact ports/ Open drain output (for relay)
MEMORY	Built-In Flash
WORKING TEMP	-10°C ~ 45°C
DIMENSIONS	LxWxH (5.75"x4.17"x0.43")

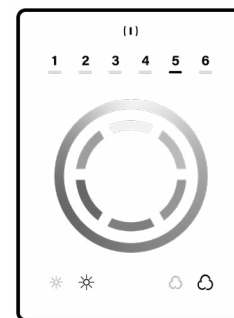

RGB-SDE3 WiFi DMX WALL CONTROLLER

INPUT VOLTAGE	6V DC, 0.6A
OUTPUT SIGNAL	DMX512 (x2)
PROGRAMMABILITY	PC/ MAC/ Tablet/ Smartphone
COLOR OPTIONS	Black/ White
CONNECTIONS	USB/ Ethernet/ RS232/ CLock/ 8dry contact ports/ 5V output relay
MEMORY	MicroSD Card
WORKING TEMP	-20°C ~ 40°C
DIMENSIONS	LxWxH (5.75"x4.17"x0.43")

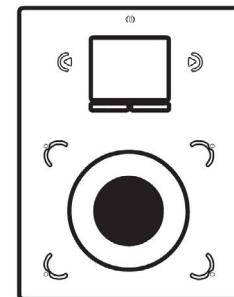

DMX DECODERS

RGB-DMX-4C-RJ45 4-CHANNEL DMX DECODER

INPUT VOLTAGE	12V-24V DC
OUTPUT CURRENT	5A X 4CH
OUTPUT WATTAGE	60W(12V), 120W(24V)
OUTPUT CHANNELS	4
DIMENSIONS	LxWxH (7"x1.77"x0.75")

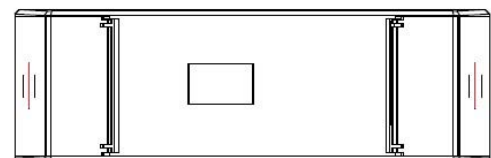

LSP-50 RGB

4.4W INDOOR COLOR-CHANGING LED STRIP

DMX DECODERS

RGB-DMX-5C-XLR 5-CHANNEL DMX DECODER

INPUT VOLTAGE	12V-24V DC
OUTPUT CURRENT	8A X 5CH
OUTPUT WATTAGE	5 x (96W ~ 192W)
OUTPUT CHANNELS	5
DIMENSIONS	LxWxH (6.45"x2.87"x1.5")

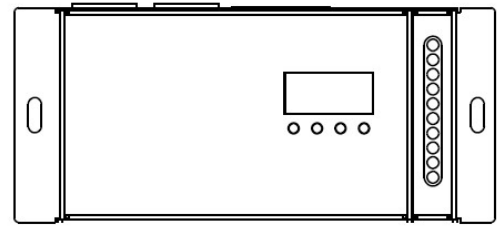

BASIC CONTROLLERS

RGB-CT550 RGBW WIRELESS RECEIVER / CONTROLLER SYSTEM

REMOTE DISTANCE	100 Ft. (Line of Sight)
FREQUENCY	2.4 GHz
DIMENSIONS	LxWxH (6.38"x1.65"x0.59")
WEIGHT	0.44lbs.

INPUT VOLTAGE	DC5V ~ DC24V
POWER CAPACITY	100W (5V) 240W (12V) 480W (24V)
OUTPUT CURRENT	5A per Channel (20A Total)
WORKING TEMP	-30°C~55°C (-22°F~131°F)
DIMENSIONS	LxWxH (6.89"x1.73"x1.18")

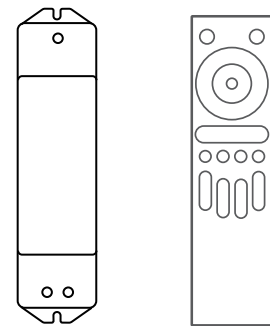

* RGB-CT500-RX (Sold Separately)

* RGB-CT500-RX
(Sold Separately)

RGB-CT700 MASTER RGBW WIFI CONTROLLER

INPUT VOLTAGE	12-24V DC
OUTPUT TYPE	Constant Voltage
POWER CAPACITY	288W (12V) 384W (24V)
OUTPUT CURRENT	5A per Channel (20A Total)
WORKING TEMP	-4°F (-20°C) ~ 122°F (50°C)
DIMENSIONS	LxWxH (7 x1.8 x 0.8")

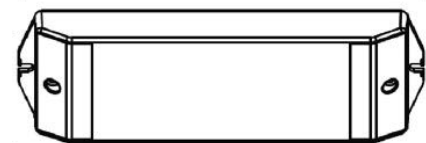

* Paired with RGB-CT705ZR (Sold Separately)

RGB-CT705ZR SLAVE RGBW WIFI CONTROLLER

INPUT VOLTAGE	12-24V DC
OUTPUT TYPE	Constant Voltage
POWER CAPACITY	288W (12V) 384W (24V)
OUTPUT CURRENT	5A per Channel (20A Total)
WORKING TEMP	-4°F (-20°C) ~ 122°F (50°C)
DIMENSIONS	LxWxH (7 x0,63 x 0.71")

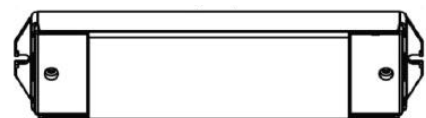

* Paired with RGB-CT700 (Sold Separately)

LSP-50 RGB

4.4W INDOOR COLOR-CHANGING LED STRIP

BASIC CONTROLLERS

RGB-CT840
BLUETOOTH TOUCH PANEL WALL CONTROLLER

INPUT VOLTAGE 12-24V DC
ZONES 4
CONTROL MODE RGB | RGBW
WIRELESS PROTOCOL Bluetooth 5.0 SIG Mesh
WORKING TEMP -20°C ~ 55°C
DIMENSIONS LxWxH (4.7"x3"x1.2")

** Paired with RGB-CT800-RC (Sold Separately)*



COMPATIBLE BASIC RECEIVERS

RGB-CT800-RC
BLUETOOTH CONSTANT VOLTAGE LED RECEIVER

INPUT VOLTAGE 12V | 24V
OUTPUT CURRENT 4Ax5CH / 5Ax4CH (20A Max)
POWER CAPACITY 240W (12V) | 480W (24V)
PROGRAMMABILITY iOS and Android
WORKING TEMP -20°C ~ 55°C
DIMENSIONS LxWxH (6.9x1.7x1.2")

** Paired with RGB-CT840 (Sold Separately)*



COMPATIBLE NON-DIMMING DRIVERS

PSHK SERIES
NON-DIMMING CONSTANT VOLTAGE WITH JUNCTION BOX

PSHK-30W-24V	CLASS 2	6.5" X 3.6" X 1.02"
PSHK-60W-24V	CLASS 2	7.4" X 3.62" X 1.02"
PSHK-96W-24V	CLASS 2	8.66" X 3.66" X 1.61"
PSHK-150W-24V		10.24" X 4.06" X 1.81"
PSHK-200W-24V		10.24" X 4.06" X 1.81"
PSHK-288W-24V	CLASS 2	11.85" X 4.25" X 1.82"
PSHK-300W-24V		10.24" X 4.25" X 1.81"

