

LSMW-60

6W OUTDOOR FLEXIBLE LED STRIP

Project _____

Location _____

Quote/ Ref # _____

LSMW-60 is an outdoor, wet-rated, dimmable LED strip capable of delivering 500 lumens of light output per Ft. Rated to last 50,000 hours making it an excellent replacement for halogen lighting. Its innovative low profile design makes it suitable for use in cove lighting, under cabinets, architectural and aesthetic enhancements.



SPECIFICATIONS

POWER CONSUMPTION	6W per Ft.
LEDS/ FT.	42 LED per Ft.
LUMEN OUTPUT	500 Lumens per Ft.
CRI	90+
COLOR TEMPERATURE	22K/ 25K/ 27K/ 30K/ 35K/ 40K/ 50K/ 60K
DIMMING	MLV, ELV, 0-10V and TRIAC
MAXIMUM RUN LENGTH	16 Ft.
CUTTABLE	Every 1 in (25.4mm)
BINNING	1.5-Step MacAdam Elipse
OPERATING VOLTAGE	24V DC
OPERATING TEMPERATURE	-40°F (-40°C) to 140°F (60°C)
BEAM ANGLE	120°
RATING	IP65 Wet Location
CERTIFICATIONS	UL Listed, California TITLE JA8
LUMEN MAINTENANCE	50,000 Hrs.

FEATURES

- 6W/ Ft.
- 16 Ft. Maximum Run Length
- 90+ CRI
- Custom length available every 1 in.
- Field Cuttable
- Dimmable with CORE dimmable drivers
- UL Listed
- California TITLE 24 JA8 Compliant
- Ideal for accent and ambient lighting
- Approved for closet/ storage space installation per NEC 410.16(A)(3) and 410.16(C)(5)



MODEL	COLOR TEMP	LED LENGTH	VOLTAGE	PROFILE
LSMW60	22K 2200K	16 16.4 Ft.	24 24V DC	<i>See Page 2 for compatible profiles.</i>
	25K 2400K	32 32 Ft.		
	25K 2700K	1XX per Ft.		
	30K 3000K			
	35K 3500K			
	40K 4000K			
	50K 5000K			
	60K 6000K	*1 = Custom length per FT. (cuttable every 1")		* Custom color finishes require powder coating. Allow 7 days leads time.

LSMW-60

6W OUTDOOR FLEXIBLE LED STRIP

DIMENSIONS

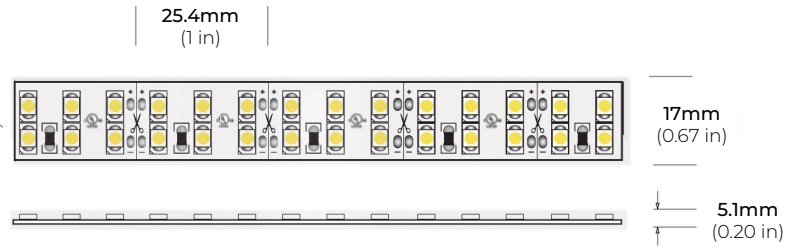

COMPATIBLE ALUMINUM PROFILES

SURFACE PROFILES

ALU-DS100

LENGTHS 39³/₈" | 78⁷/₈" | 84"
LENS Clear, Frosted
FINISH Silver

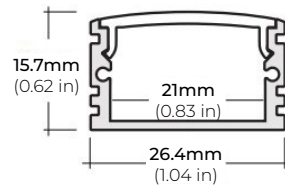

ALP-90

LENGTHS 49.25" | 98.5"
LENS Frosted
FINISH White | Black | Silver

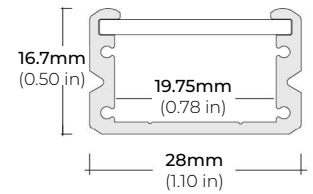

ALP-130

LENGTHS 49.25" | 84" | 98.5"
LENS Frosted
FINISH Black | Silver

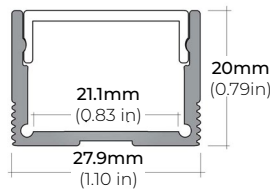

ALP-140

LENGTHS 49.25" | 98.5"
LENS Frosted
FINISH Silver

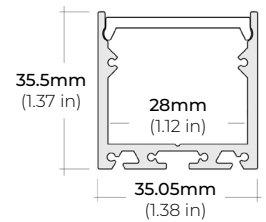

ALP-160

LENGTHS 49.25" | 98.5"
LENS Frosted
FINISH Silver

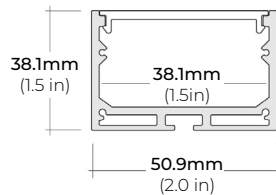

ALP-310N

LENGTHS 49.25" | 98.5"
LENS Frosted
FINISH Silver

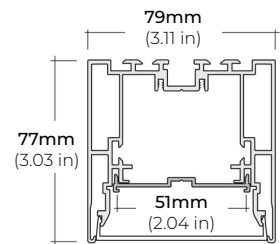

RECESSED PROFILES

ALP-210RN

LENGTHS 49.25" | 98.5"
LENS Frosted
FINISH Silver

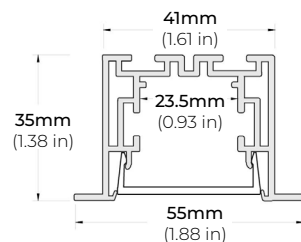

ALP-340R

LENGTHS 49.25" | 98.58"
LENS Frosted
FINISH Silver

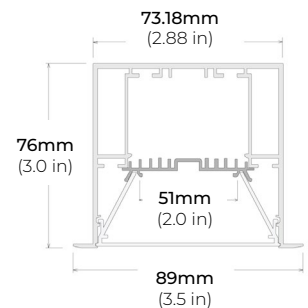

* For more compatible profiles, visit corelightingusa.com

LSMW-60

6W OUTDOOR FLEXIBLE LED STRIP

COMPATIBLE TRANSFORMERS

PSDL SERIES TRIAC DIMMABLE

PSDL-30W-24V	CLASS 2	6.5" X 3.63" X 1.58"
PSDL-60W-24V	CLASS 2	7.4" X 3.63" X 1.58"
PSDL-96W-24V	CLASS 2	8.67" X 3.67 X 1.62"
PSDL-150W-24V		10.25" X 4.06" X 1.82"
PSDL-192W-24V	CLASS 2	11" X 4" X 1.82"
PSDL-200W-24V		10.25" X 4.06" X 1.82"
PSDL-288W-24V	CLASS 2	11.85" X 4.25" X 1.82"
PSDL-300W-24V		10.25" X 4.06" X 1.82"

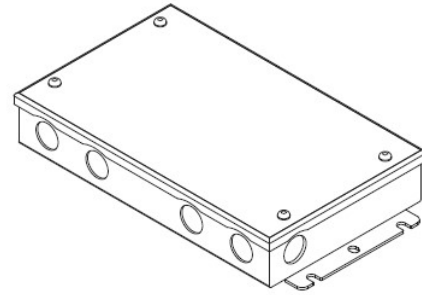

PSDH SERIES HIGH PERFORMANCE MAGNETIC LOW VOLTAGE (MLV)

PSDH-48W-24V	CLASS 2	11.25" X 3.38" X 3.38"
PSDH-96W-24V	CLASS 2	11.25" X 3.38" X 3.37"
PSDH-288W-24V	CLASS 2	14.25" X 8.43" X 4.43"

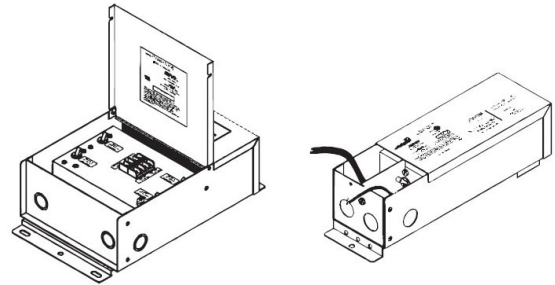

PSRX SERIES 4-IN-1 DIMMING DRIVER W/ JUNCTION BOX

PSRX-30W-24V-UNV	CLASS 2	6.5" X 3.7" X 1.57"
PSRX-60W-24V-UNV	CLASS 2	7.4" X 3.72" X 1.57"
PSRX-96W-24V-UNV	CLASS 2	8.66" X 3.72" X 1.57"
PSRX-150W-24V-UNV		10.24" X 4.13" X 1.77"
PSRX-200W-24V-UNV		10.24" X 4.13" X 1.77"
PSRX-300W-24V-UNV		10.94" X 4.33" X 1.77"

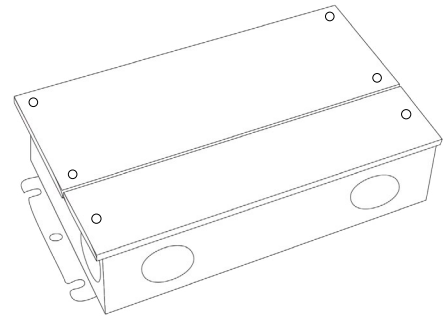

PSVT SERIES 0-10V DIMMING WITH JUNCTION BOX

PSVT-60W-24V-UNV-010	CLASS 2	7.4" X 3.72" X 1.57"
PSVT-96W-24V-UNV-010	CLASS 2	8.66" X 3.72" X 1.57"
PSVT-200W-24V-UNV-010		10.24" X 4.13" X 1.77"
PSVT-288W-24V-UNV-010	CLASS 2	11.85" X 4.25" X 1.81"
PSVT-300W-24V-UNV-010		10.94" X 4.33" X 1.77"

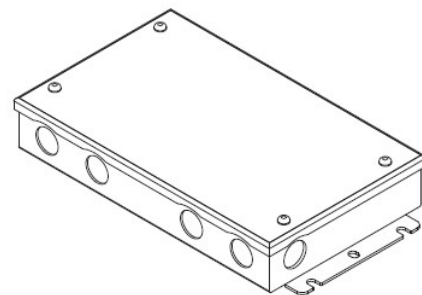

LSMW-60

6W OUTDOOR FLEXIBLE LED STRIP

COMPATIBLE TRANSFORMERS

PSDE SERIES

0-10V DIMMING W/ JUNCTION BOX

PSDE-60W-24V-010-JB	CLASS 2	12.1" X 2.36" X 1.4"
PSDE-96W-24V-010-JB	CLASS 2	12.1" X 2.36" X 1.4"

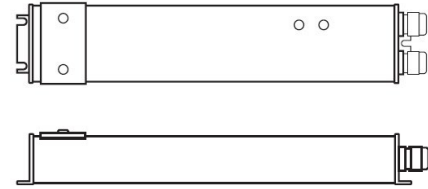

LUTRON 1%

2 OR 3-WIRE DIMMING

LTEA4U1UKL-CV240	CLASS 2	4.89" X 4" X 2.62"
L3DA4U1UKL-CV240	CLASS 2	4.89" X 4" X 2.62"

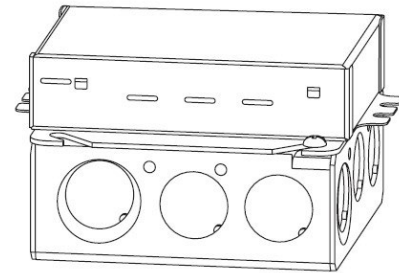

LUTRON 1%

PSDE-96W-24V-ECO	CLASS 2	10.5" X 3.0" X 2.0"
------------------	---------	---------------------

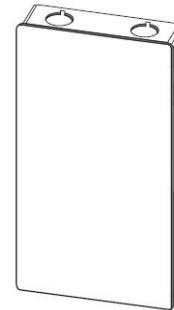

COMPATIBLE NON-DIMMING DRIVERS

PSHK SERIES

NON-DIMMING CONSTANT VOLTAGE WITH JUNCTION BOX

PSHK-30W-24V	CLASS 2	6.5" X 3.6" X 1.02"
PSHK-60W-24V	CLASS 2	7.4" X 3.62" X 1.02"
PSHK-96W-24V	CLASS 2	8.66" X 3.66" X 1.61"
PSHK-150W-24V		10.24" X 4.06" X 1.81"
PSHK-200W-24V		10.24" X 4.06" X 1.81"
PSHK-288W-24V	CLASS 2	11.85" X 4.25" X 1.82"
PSHK-300W-24V		10.24" X 4.25" X 1.81"

