

KT-EX-ELNY1-WH3RL-RU

EXIT SIGN

DESCRIPTION

LED Exit Sign | Single or Double Facing | NYC Compliant |
White Finish | Red Lettering | Recessed Mount |
Battery Backup | Built-in Test Switch | 120-277V Input

APPLICATION

UL 924 Compliant Exit Sign with Built-in Red Lettering and Recessed Mounting, New York City Code Compliant. Provides 90 Minutes of Emergency Power.



PRODUCT FEATURES

- Red LED Color
- Includes Single or Double Facing Configurations
- Recessed Mount
- Integrated Backup Battery - NiMH 500mAh
- 90 Minutes of Emergency Power
- Integrated Test Switch & Charge Indicator
- New York City Code Compliant Design
- Thermoplastic Housing and Aluminum Recessed Bracket - UL 94 5VA Flame Rating
- Ambient Operating Temperature: 0°C/32°F to 40°C/104°F
- UL Certified for Damp Locations
- Universal J-Box Mounting Pattern
- Acrylic Exit Panel with Mirrored Backing

PERFORMANCE SPECIFICATIONS

Catalog Number	Input Voltage	Input Power	Letter Color	Housing Color	Mounting	Battery Type	Battery Capacity	Recharge Time	Remote Capable
KT-EX-ELNY1-WH3RL-RU	120-277V	3.2W	Red	White	Recessed Mount	Nickel-Metal Hydride	500mAh	24 Hours	No

* See Ordering Information and Catalog Number Breakdown for more details.

PHYSICAL SPECIFICATIONS

Weight

Fixture Weight	Carton Weight
6.2 lbs	15.7 lbs

KT-EX-ELNY1-WH3RL-RU EXIT SIGN

FIELD-ADJUSTABLE FEATURES: CHEVRONS, FACINGS & MOUNTING ORIENTATION

This fixture is equipped with field-adjustable removable chevrons, single (front only) or double (front and back) faceplates, and three mounting options (top, side, or back).

Note: Ensure power is off to the fixture and rechargeable battery is disconnected before making any adjustments.

Use of Chevrons

Remove peelable chevron(s) on faceplate, as needed.

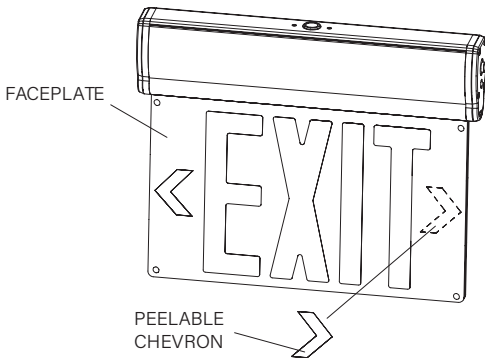

Single or Double-Sided Facing

This fixture ships with a back panel to allow for either single- or double-sided Exit Sign. If single-sided is desired, back panel will be attached to exit panel. For double-sided use, the back panel will not be utilized.

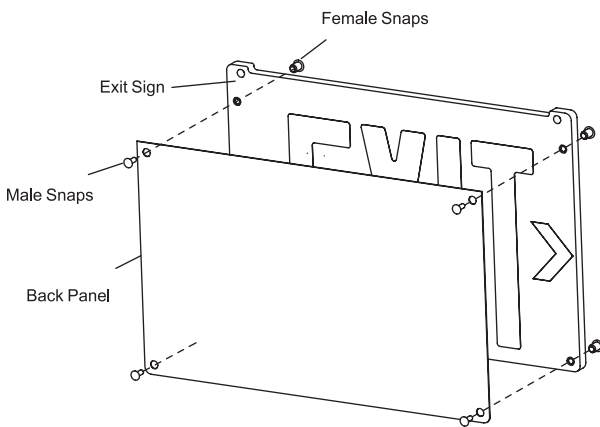

KT-EX-ELNY1-WH3RL-RU

EXIT SIGN

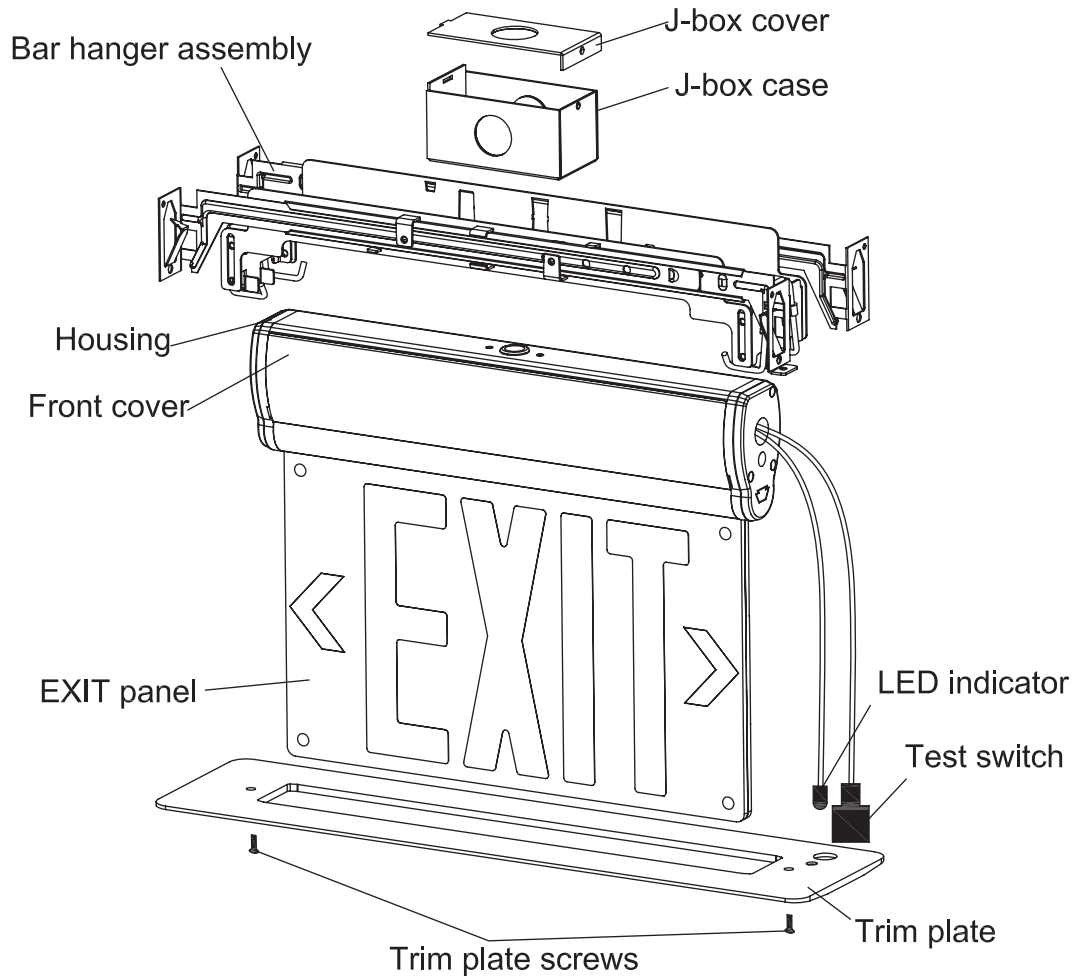

SMART//SAFE®

KT-EX-ELNY1-WH3RL-RU

EXIT SIGN

ORDERING INFORMATION

Catalog Number	Finish	UPC	Easy Code
KT-EX-ELNY1-WH3RL-RU	White	843654165097	JVC-46

CATALOG NUMBER BREAKDOWN

KT-EX-ELNY1-WH3RL-RU

1 2 3 4 5 6 7 8 9

1 Keystone Technologies

2 Exit Sign

3 Edge Lit - New York City Compliant

4 Form Factor 1

5 Housing Color

6 Facings

7 Lettering Color

8 Mounting

9 Input Voltage

5 Housing Color

WH

White

6 Facings

3

Single and Double

7 Lettering Color

R

Red Lettering

8 Mounting

R

Recessed Mount

9 Input Voltage

U

120-277V