

KT-EX-EL1-WH3XL-SU

EXIT SIGN

DESCRIPTION

LED Exit Sign | Single or Double Facing |
White Finish | Red or Green Lettering | Surface Mount |
Battery Backup | Built-in Test Switch | 120-277V Input

APPLICATION

UL 924 Compliant Exit Sign with Built-in Red or Green Lettering. Provides 90 Minutes of Emergency Power.

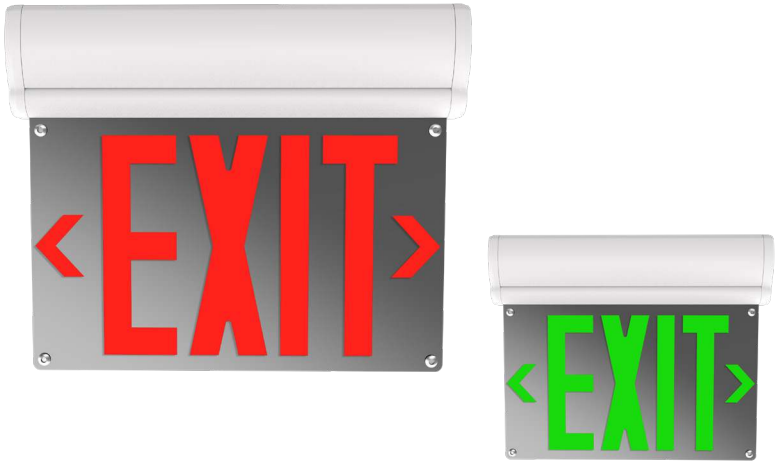

PRODUCT FEATURES

- Red or Green LED Color
- Includes Single or Double Facing Configurations
- Surface Mount - Back, Side, or Top
- Integrated Backup Battery - NiMH 500mAh
- 90 Minutes of Emergency Power
- Integrated Test Switch & Charge Indicator
- Thermoplastic Housing - UL 94 5VA Flame Rating
- Ambient Operating Temperature: 0°C/32°F to 40°C/104°F
- UL Certified for Damp Locations
- Universal J-Box Mounting Pattern
- Acrylic Exit Panel with Mirrored Backing

PERFORMANCE SPECIFICATIONS

Catalog Number	Input Voltage	Input Power	Letter Color	Housing Color	Mounting	Battery Type	Battery Capacity	Recharge Time	Remote Capable
KT-EX-EL1-WH3RL-SU	120-277V	1.7W	Red	White	Surface: Top, Side, and Back Mount	Nickel-Metal Hydride	500 mAh	24 Hours	No
KT-EX-EL1-WH3GL-SU			Green						

* See Ordering Information and Catalog Number Breakdown for more details.

PHYSICAL SPECIFICATIONS

Weight

Fixture Weight	Carton Weight
2.3 lbs	16.9 lbs

KT-EX-EL1-WH3XL-SU EXIT SIGN

FIELD-ADJUSTABLE FEATURES: CHEVRONS, FACINGS & MOUNTING ORIENTATION

This fixture is equipped with field-adjustable removable chevrons, single (front only) or double (front and back) faceplates, and three mounting options (top, side, or back).

Note: Ensure power is off to the fixture and rechargeable battery is disconnected before making any adjustments.

Use of Chevrons

Remove peelable chevron(s) on faceplate, as needed.

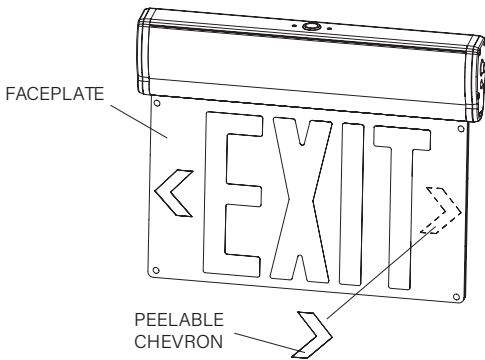

Single or Double-Sided Facing

This fixture ships with a back panel to allow for either single-sided or double-sided Exit Sign. If single-sided is desired, back panel will be attached to exit panel. For double-sided use, the back panel will not be utilized.

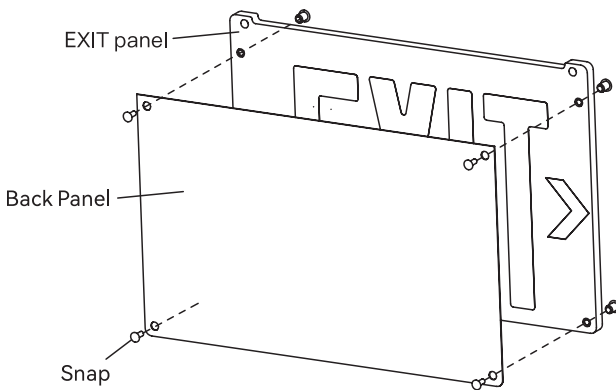

KT-EX-EL1-WH3XL-SU

EXIT SIGN

MOUNTING OPTIONS

BACK MOUNT



TOP MOUNT



SIDE MOUNT

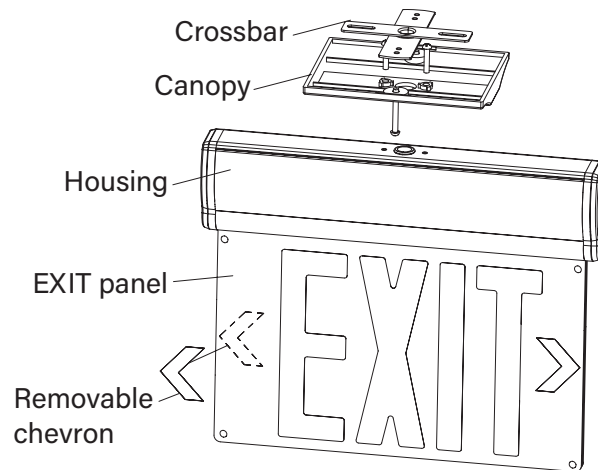
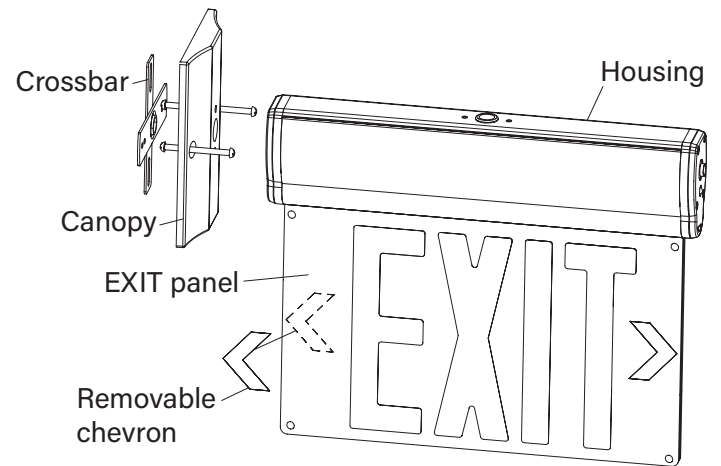
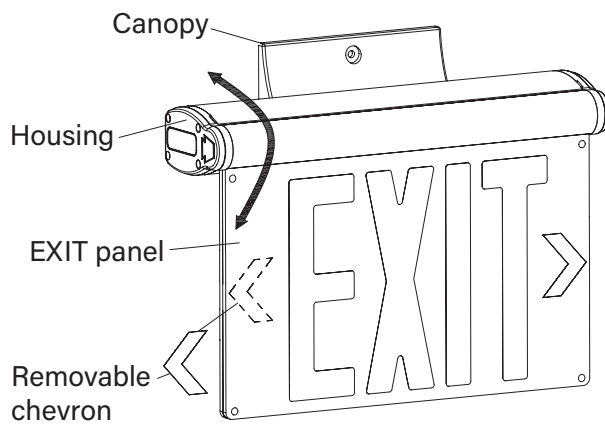

SMART//SAFE®

KT-EX-EL1-WH3XL-SU

EXIT SIGN

ORDERING INFORMATION

Catalog Number	Lettering	UPC	Easy Code
KT-EX-EL1-WH3RL-SU	Red	843654165059	STO-03
KT-EX-EL1-WH3GL-SU	Green	843654165066	FMM-67

CATALOG NUMBER BREAKDOWN

KT-EX-EL1-WH3XL-SU

1 2 3 4 5 6 7 8 9

- 1 Keystone Technologies
- 2 Exit Sign
- 3 Edge Lit
- 4 Form Factor 1
- 5 Housing Color
- 6 Facings
- 7 Lettering Color
- 8 Mounting
- 9 Input Voltage

5 Housing Color

WH White

6 Facings

3 Single and Double

7 Lettering Color

RL Red Lettering
GL Green Lettering

8 Mounting

S Surface Mount

9 Input Voltage

U 120-277V