

# KT-EC-TP3-WH3RW-SD

## EXIT COMBO

### DESCRIPTION

LED Exit Combo | Single or Double Facing | Dual Heads |  
Wet Rated | White Finish | 6500K White Light | Surface Mount |  
Battery Backup | Built-in Test Switch | 120/277V Input

### APPLICATION

UL 924 Compliant Wet Rated Exit Combo with Built-in Red Lettering. Provides 90+ Minutes of Emergency Power.



### PRODUCT FEATURES

- Red LED and Diffuser Color
- Includes Single or Double Facing Configurations
- Surface Mount - Back and Side
- Integrated Backup Battery - NiMH - 1200mAh
- 90 Minutes of Emergency Power
- Integrated Test Switch & Charge Indicator
- UL Certified for Wet Locations
- Thermoplastic Housing - UL 94 5VA Flame Rating
- Ambient Operating Temperature: 0°C/32°F to 40°C/104°F
- Universal J-Box Mounting Pattern

### PERFORMANCE SPECIFICATIONS

| Catalog Number     | Input Voltage | Input Power                 | CCT   | Lumens | Letter Color | Housing Color | Mounting                     | Battery Type         | Battery Capacity | Recharge Time | Remote Capable |
|--------------------|---------------|-----------------------------|-------|--------|--------------|---------------|------------------------------|----------------------|------------------|---------------|----------------|
| KT-EC-TP3-WH3RW-SD | 120/277V      | 2.9W (120V)<br>3.79W (277V) | 6500K | 300    | Red          | White         | Surface: Side and Back Mount | Nickel-Metal Hydride | 1200mAh          | 24 Hours      | No             |

\* See Ordering Information and Catalog Number Breakdown for more details.

### PHYSICAL SPECIFICATIONS

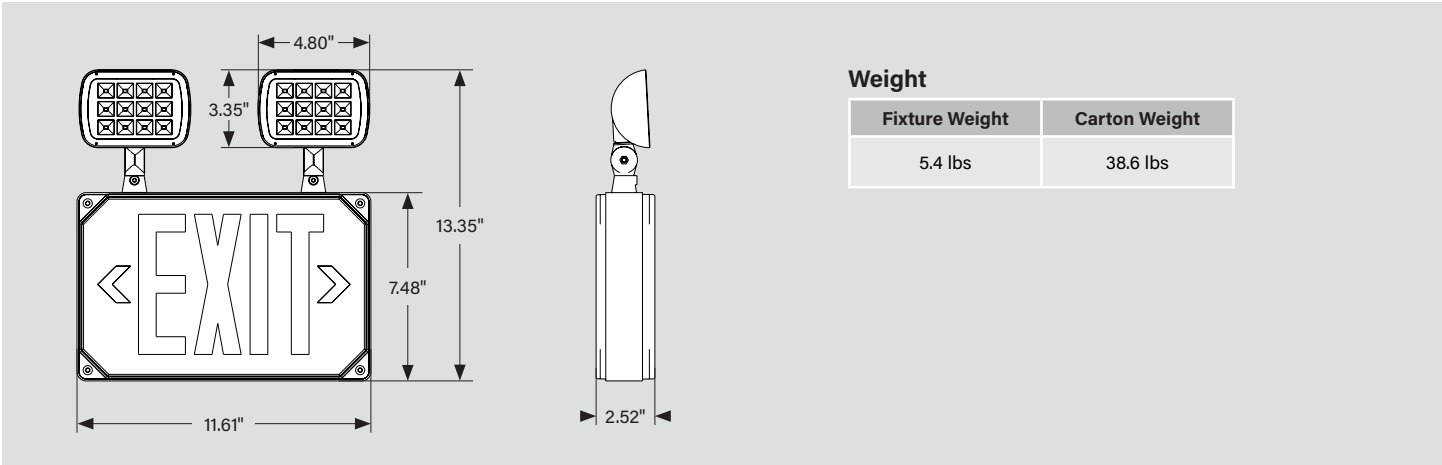

## KT-EC-TP3-WH3RW-SD EXIT COMBO

### FIELD-ADJUSTABLE FEATURES: CHEVRONS, FACINGS & MOUNTING ORIENTATION

This fixture is equipped with field-adjustable removable chevrons, single (front only) or double (front and back) faceplates, and three mounting options (top, side, or back).

*Note: Ensure power is off to the fixture and rechargeable battery is disconnected before making any adjustments.*

#### Use of Chevrons

Remove punchout chevron(s) on faceplate, as needed. The diffuser would need to be removed to allow chevron removal. Re-secure diffuser after chevron removal.

FACEPLATE

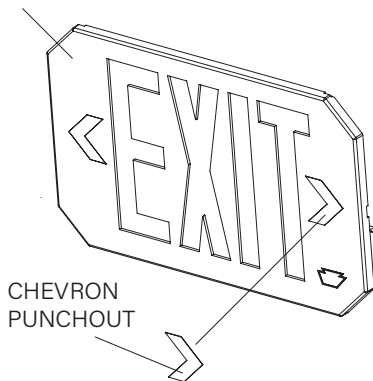

#### Single or Double-Sided Faceplates

This fixture ships with two "EXIT" sign faceplates and one back/solid faceplate to allow for either single- or double-sided Exit Sign. Single-sided Exit Sign will use one "EXIT" faceplate and the back/solid faceplate, while double-sided Exit Sign will use two "EXIT" faceplates. All three faceplates are included.

# KT-EC-TP3-WH3RW-SD EXIT COMBO

## MOUNTING OPTIONS

### BACK MOUNT



### SIDE MOUNT

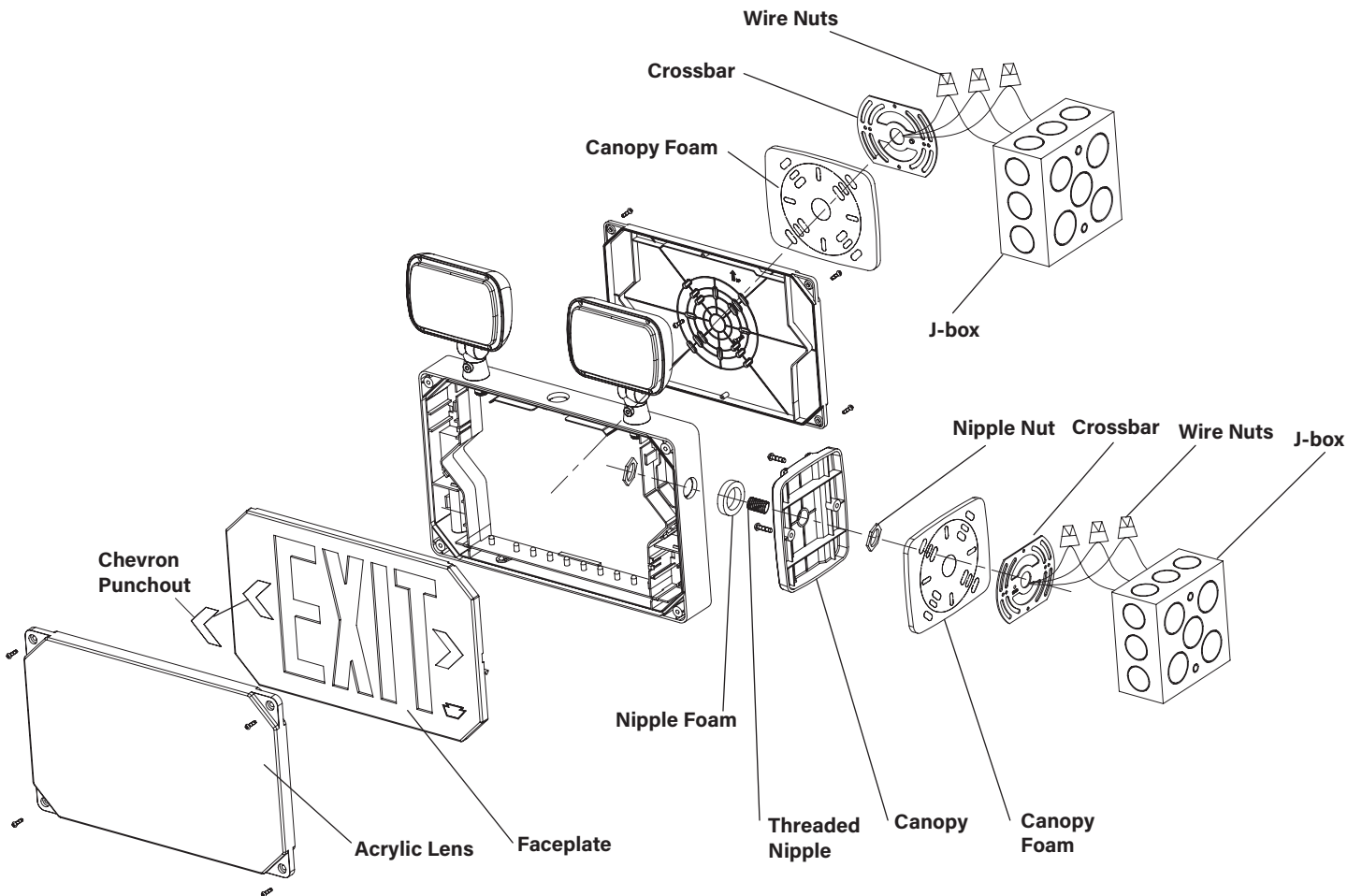

# KT-EC-TP3-WH3RW-SD

## EXIT COMBO

### SPACING GUIDELINES

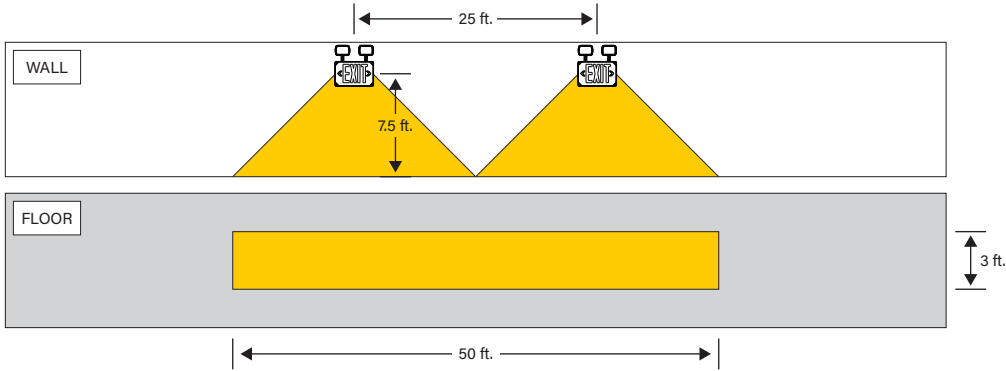

| Multiple Unit Spacing |                            |
|-----------------------|----------------------------|
| Room Description      | 8' x 12' Hallway           |
| Head Orientation      | 30° Rotation, 45° Tilt     |
| Path of Egress        | 3' Wide                    |
| Illumination          | 1fc average, 0.1fc minimum |

\*Spacing guidelines provided are for general reference only. Actual performance will vary based on each installations unique dimensions, wall colors, floor type, and other factors. Please contact [lightinglayouts@keystonetech.com](mailto:lightinglayouts@keystonetech.com) for detailed layout assistance needs.

### ORDERING INFORMATION

| Catalog Number     | Finish | UPC          | Easy Code |
|--------------------|--------|--------------|-----------|
| KT-EC-TP3-WH3RW-SD | White  | 843654165288 | TBZ-05    |

### CATALOG NUMBER BREAKDOWN

# KT-EC-TP3-WH3RW-SD

- 1
- 2
- 3
- 4
- 5
- 6
- 7
- 8
- 9
- 10

- 1 Keystone Technologies
- 2 Exit Combo
- 3 Thermo Plastic
- 4 Form Factor 3
- 5 Housing Color
- 6 Facings
- 7 Lettering Color
- 8 Light Color
- 9 Mounting
- 10 Input Voltage

#### 5 Housing Color

|    |       |
|----|-------|
| WH | White |
|----|-------|

#### 8 Light Color

|   |       |
|---|-------|
| W | White |
|---|-------|

#### 6 Facings

|   |                   |
|---|-------------------|
| 3 | Single and Double |
|---|-------------------|

#### 9 Mounting

|   |               |
|---|---------------|
| S | Surface Mount |
|---|---------------|

#### 7 Lettering Color

|    |                         |
|----|-------------------------|
| RG | Red and Green Lettering |
|----|-------------------------|

#### 10 Input Voltage

|   |          |
|---|----------|
| D | 120/277V |
|---|----------|