

KT-EC-TP2-XX3RGW-SU

EXIT COMBO

DESCRIPTION

LED Exit Combo | Single or Double Facing | Dual Heads |
Switchable Red and Green Lettering |
White or Black Finish | 6500K White Light | Surface Mount |
Battery Backup | Built-in Test Switch | 120-277V Input

APPLICATION

UL 924 Compliant Exit Combo with Built-in Red or Green Switchable Lettering. Provides 90+ Minutes of Emergency Power.



Available in Black Housing Color



Red & Green Lettering Options Included

PRODUCT FEATURES

- Red or Green Switchable LED and Diffuser Color
- Includes Single or Double Facing Configurations
- Surface Mount - Back, Side, or Top
- Integrated Backup Battery - NiCad 1000mAh
- 90 Minutes of Emergency Power
- Integrated Test Switch & Charge Indicator
- Adjustable Dual Heads
- Thermoplastic Housing - UL 94V-0 Flame Rating
- Ambient Operating Temperature: 0°C/32°F to 40°C/104°F
- UL Certified for Damp Locations
- Universal J-Box Mounting Pattern

PERFORMANCE SPECIFICATIONS

| Catalog Number | Input Voltage | Input Power | CCT | Lumens | Letter Color | Housing Color | Mounting | Battery Type | Battery Capacity | Recharge Time | Remote Capable |
|---------------------|---------------|-------------|-------|--------|--------------|---------------|------------------------------------|----------------|------------------|---------------|----------------|
| KT-EC-TP2-WH3RGW-SU | 120-277V | 2W | 6500K | 160 | Red & Green | White | Surface: Top, Side, and Back Mount | Nickel-Cadmium | 1000mAh | 24 Hours | No |
| KT-EC-TP2-BL3RGW-SU | | | | | | Black | | | | | |

* See Ordering Information and Catalog Number Breakdown for more details.

PHYSICAL SPECIFICATIONS

Weight

| Fixture Weight | Carton Weight |
|----------------|---------------|
| 2.4 lbs | 16.8 lbs |

KT-EC-TP2-XX3RGW-SU EXIT COMBO

FIELD-ADJUSTABLE FEATURES: LED COLOR, DIFFUSER COLOR, CHEVRONS, FACINGS & MOUNTING ORIENTATION

This fixture is equipped with field-adjustable red or green LED color and colored diffusers, removable chevrons, single (front only) or double (front and back) facings, and three mounting options (top, side, or back).

Note: Ensure power is off to the fixture and rechargeable battery is disconnected before making any adjustments.

Selectable Color

Select the diffuser color of choice. Face plates ship with Red Diffuser already installed. To use Green Diffuser, remove the Red Diffuser and secure the Green Diffuser to Face Plate(s).

Toggle the switchable button to choose red or green illumination.

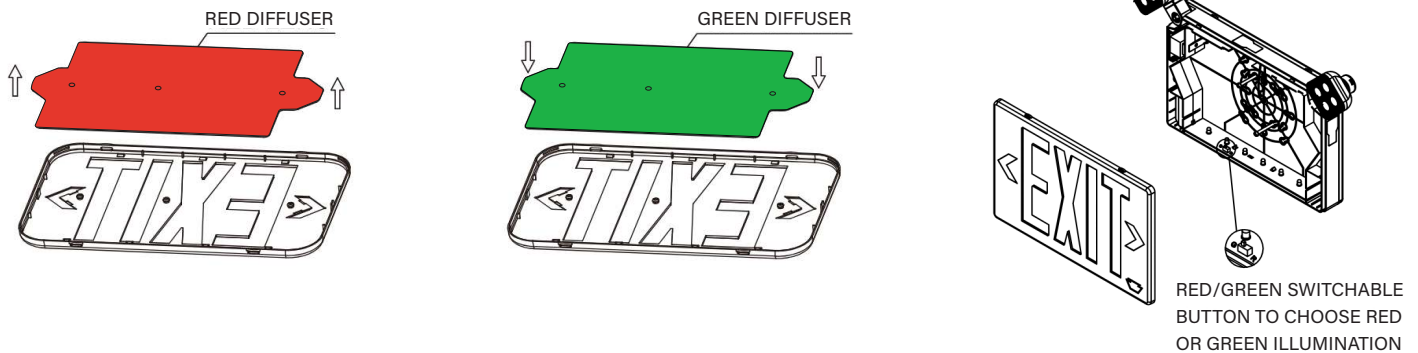

Use of Chevrons

Remove punchout chevron(s) on faceplate, as needed. The diffuser would need to be removed to allow chevron removal. Re-secure diffuser after chevron removal.

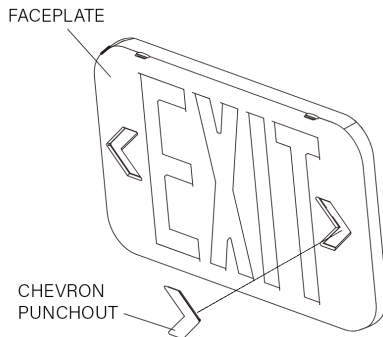

Single or Double-Sided Facing

This fixture ships with two "EXIT" sign faceplates and one back/solid faceplate to allow for either single- or double-sided Exit Sign. Single-sided Exit Sign will use one "EXIT" faceplate and the back/solid faceplate, while double-sided Exit Sign will use two "EXIT" faceplates. All three faceplates are included.

KT-EC-TP2-XX3RGW-SU

EXIT COMBO

MOUNTING OPTIONS

BACK MOUNT



TOP MOUNT



SIDE MOUNT

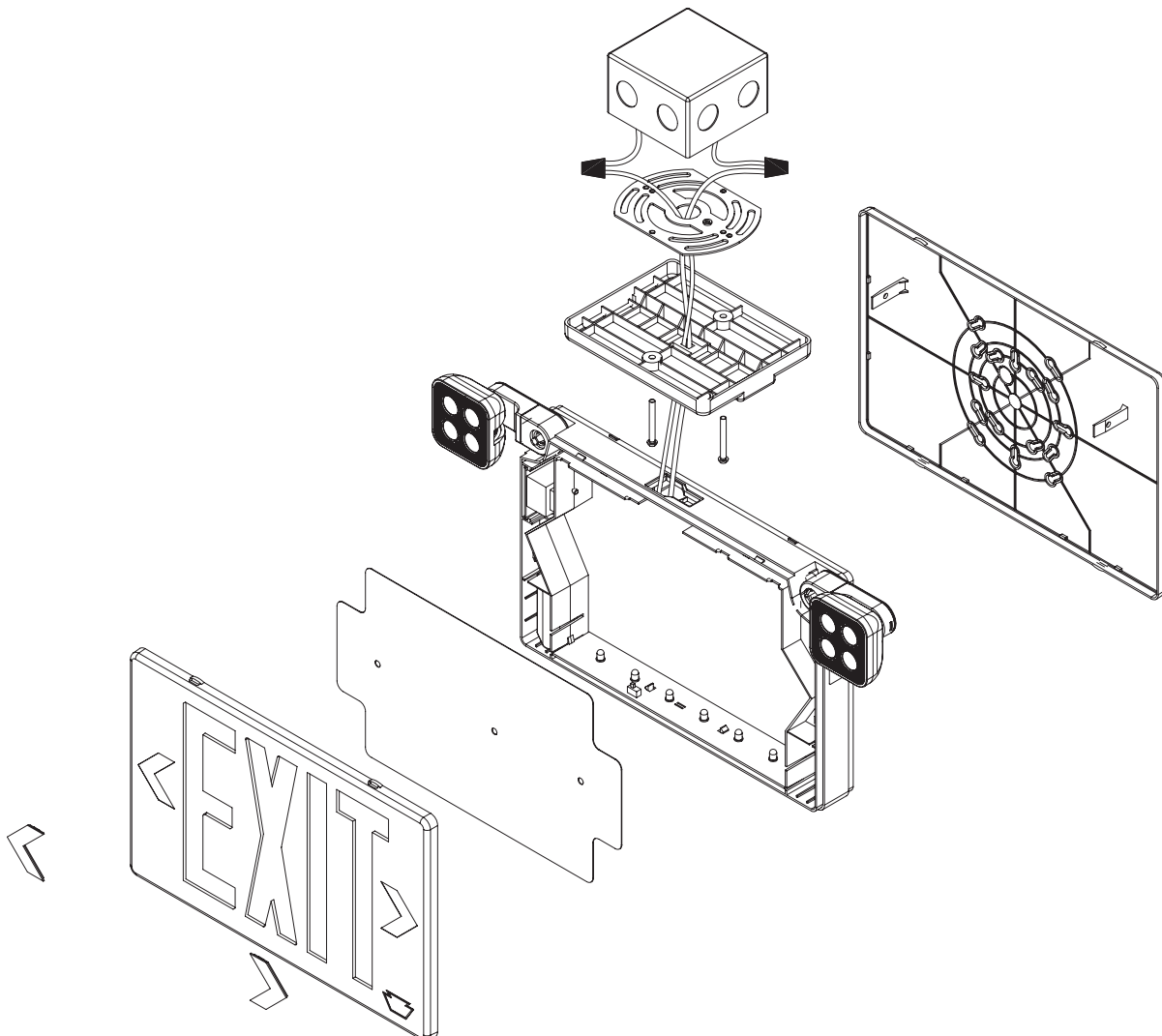

KT-EC-TP2-XX3RGW-SU

EXIT COMBO

SPACING GUIDELINES

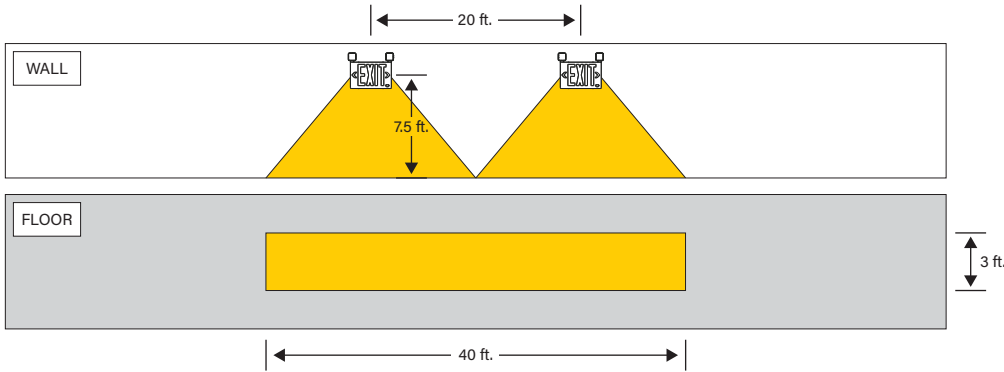

| Multiple Unit Spacing | |
|-----------------------|----------------------------|
| Room Description | 8' x 12' Hallway |
| Head Orientation | 30° Rotation, 40° Tilt |
| Path of Egress | 3' Wide |
| Illumination | 1fc average, 0.1fc minimum |

*Spacing guidelines provided are for general reference only. Actual performance will vary based on each installations unique dimensions, wall colors, floor type, and other factors. Please contact lightinglayouts@keystonetech.com for detailed layout assistance needs.

ORDERING INFORMATION

| Catalog Number | Finish | UPC | Easy Code |
|---------------------|--------|--------------|-----------|
| KT-EC-TP2-WH3RGW-SU | White | 843654165240 | DDY-20 |
| KT-EC-TP2-BL3RGW-SU | Black | 843654165257 | HTR-84 |

CATALOG NUMBER BREAKDOWN

KT-EC-TP2-XX3RGW-SU

1 2 3 4 5 6 7 8 9 10

1 Keystone Technologies

2 Exit Combo

3 Thermo Plastic

4 Form Factor 2

5 Housing Color

6 Facings

7 Lettering Color

8 Light Color

9 Mounting

10 Input Voltage

5 Housing Color

| | |
|----|-------|
| WH | White |
| BL | Black |

8 Light Color

| | |
|---|-------|
| W | White |
|---|-------|

6 Facings

| | |
|---|-------------------|
| 3 | Single and Double |
|---|-------------------|

9 Mounting

| | |
|---|---------------|
| S | Surface Mount |
|---|---------------|

7 Lettering Color

| | |
|----|-------------------------|
| RG | Red and Green Lettering |
|----|-------------------------|

10 Input Voltage

| | |
|---|----------|
| U | 120-277V |
|---|----------|