

KT-EC-TP1-XX3RGW-SD

EXIT COMBO

DESCRIPTION

LED Exit Combo | Single or Double Facing | Dual Heads |
Switchable Red and Green Lettering |
White or Black Finish | 6500K White Light | Surface Mount |
Battery Backup | Built-in Test Switch | 120/277V Input

APPLICATION

UL 924 Compliant Exit Combo with Built-in Red or Green Switchable Lettering. Provides 90+ Minutes of Emergency Power.



Available in Black Housing Color



Red & Green Lettering Options Included

PRODUCT FEATURES

- Red or Green Switchable LED and Diffuser Color
- Includes Single or Double Facing Configurations
- Surface Mount - Back and Top
- Integrated Backup Battery - NiMH 1200mAh
- 90 Minutes of Emergency Power
- Integrated Test Switch & Charge Indicator
- Thermoplastic Housing - UL 94 5VA Flame Rating
- Ambient Operating Temperature: 0°C/32°F to 40°C/104°F
- UL Certified for Damp Locations
- Universal J-Box Mounting Pattern

PERFORMANCE SPECIFICATIONS

Catalog Number	Input Voltage	Input Power	CCT	Lumens	Letter Color	Housing Color	Mounting	Battery Type	Battery Capacity	Recharge Time	Remote Capable
KT-EC-TP1-WH3RGW-SD	120/277V	3.5W	6500K	200	Red & Green	White	Surface: Top and Back Mount	Nickel-Metal Hydride	1200mAh	24 Hours	No
KT-EC-TP1-BL3RGW-SD						Black					

* See Ordering Information and Catalog Number Breakdown for more details.

PHYSICAL SPECIFICATIONS

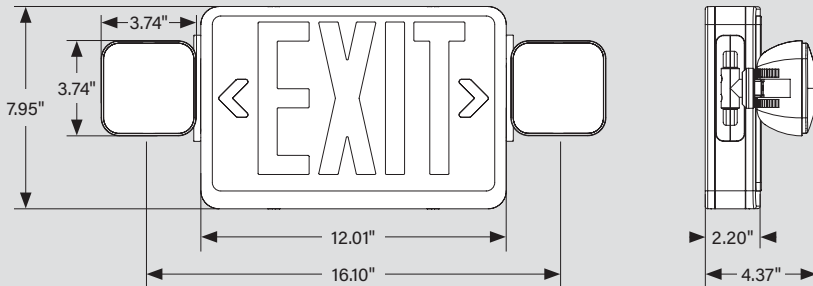

Weight

Fixture Weight	Carton Weight
3.4 lbs	26.5 lbs

KT-EC-TP1-XX3RGW-SD EXIT COMBO

FIELD-ADJUSTABLE FEATURES: LED COLOR, DIFFUSER COLOR, CHEVRONS, FACINGS & MOUNTING ORIENTATION

This fixture is equipped with field-adjustable red or green LED color and colored diffusers, removable chevrons, single (front only) or double (front and back) facings, and three mounting options (top, side, or back).

Note: Ensure power is off to the fixture and rechargeable battery is disconnected before making any adjustments.

Selectable Color

Select the diffuser color of choice. Face plates ship with Red Diffuser already installed. To use Green Diffuser, remove the Red Diffuser and secure the Green Diffuser to Face Plate(s).

Toggle the switchable button to choose red or green illumination.

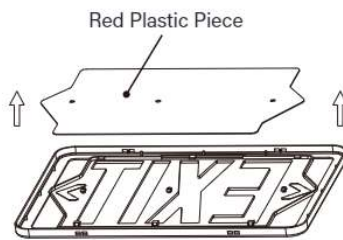

FIG. A

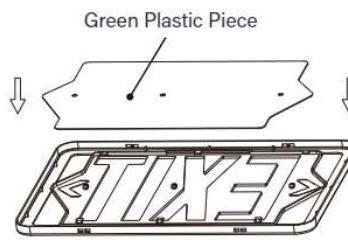

FIG. B

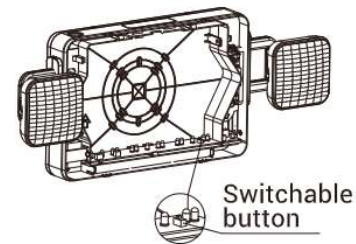
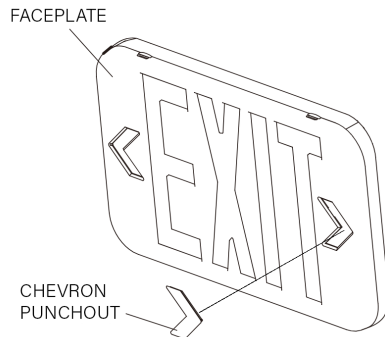

FIG. C

Use of Chevrons

Remove punchout chevron(s) on faceplate, as needed. The diffuser would need to be removed to allow chevron removal. Re-secure diffuser after chevron removal.



Single or Double-Sided Facing

This fixture ships with two "EXIT" sign faceplates and one back/solid faceplate to allow for either single- or double-sided Exit Sign. Single-sided Exit Sign will use one "EXIT" faceplate and the back/solid faceplate, while double-sided Exit Sign will use two "EXIT" faceplates. All three faceplates are included.

KT-EC-TP1-XX3RGW-SD

EXIT COMBO

MOUNTING OPTIONS

BACK MOUNT



TOP MOUNT

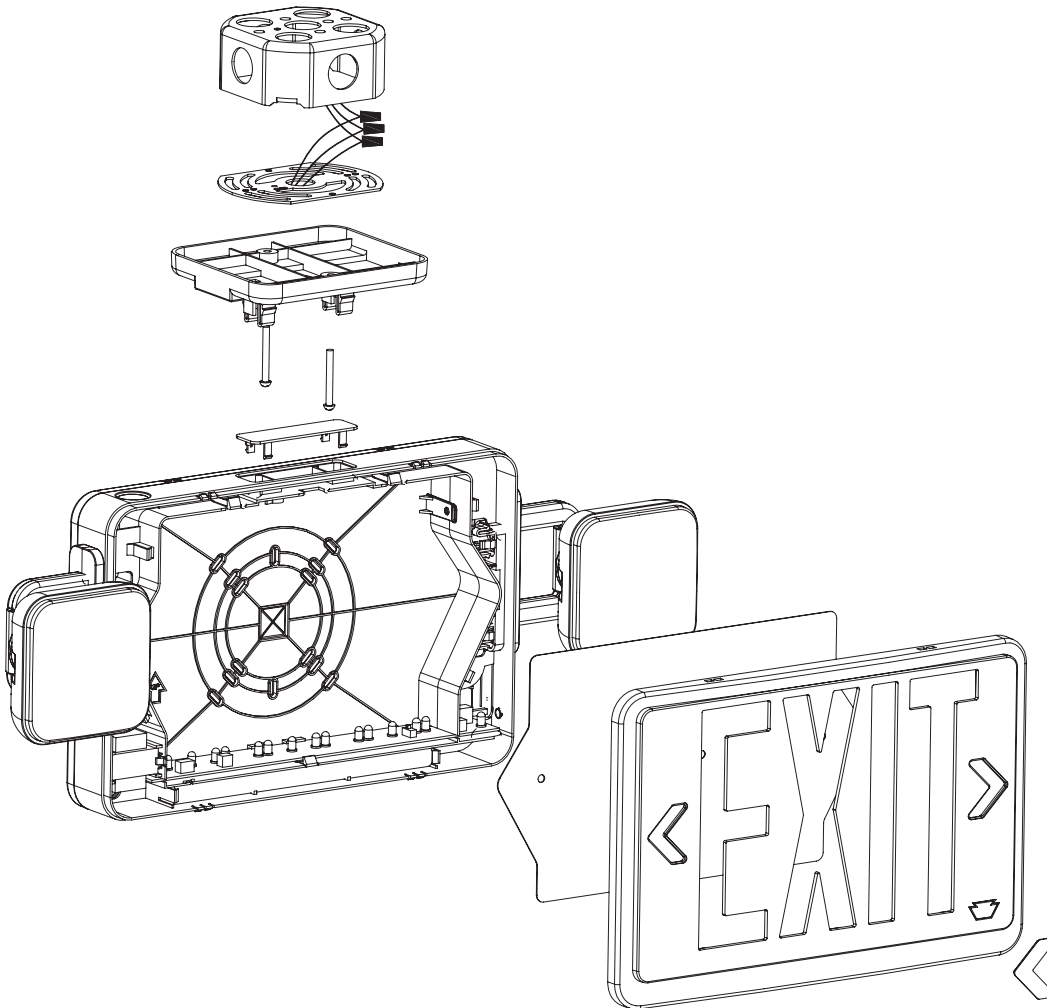

KT-EC-TP1-XX3RGW-SD

EXIT COMBO

SPACING GUIDELINES

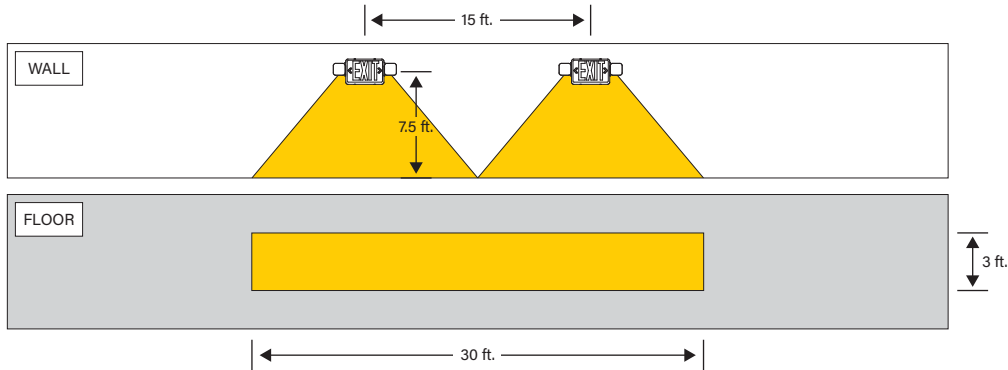

Multiple Unit Spacing	
Room Description	8' x 12' Hallway
Head Orientation	30° Rotation, 35° Tilt
Path of Egress	3' Wide
Illumination	1fc average, 0.1fc minimum

*Spacing guidelines provided are for general reference only. Actual performance will vary based on each installation's unique dimensions, wall colors, floor type, and other factors. Please contact lightinglayouts@keystonetech.com for detailed layout assistance needs.

ORDERING INFORMATION

Catalog Number	Finish	UPC	Easy Code
KT-EC-TP1-WH3RGW-SD	White	843654169255	TGI-18
KT-EC-TP1-BL3RGW-SD	Black	843654169262	TKM-92

CATALOG NUMBER BREAKDOWN

KT-EC-TP1-XX3RGW-SD

1 2 3 4 5 6 7 8 9 10

- 1 Keystone Technologies
- 2 Exit Combo
- 3 Thermo Plastic
- 4 Form Factor 1
- 5 Housing Color
- 6 Facings
- 7 Lettering Color
- 8 Light Color
- 9 Mounting
- 10 Input Voltage

5 Housing Color

WH	White
BL	Black

8 Light Color

W	White
---	-------

6 Facings

3	Single and Double
---	-------------------

9 Mounting

S	Surface Mount
---	---------------

7 Lettering Color

RG	Red and Green Lettering
----	-------------------------

10 Input Voltage

D	120/277V
---	----------