



# Getting Started Guide

---

VOICE DIMMER  
with Amazon Alexa Built-in



alexabuilt-in

decora smart™

Cat. No. DWVAA

WEB VERSION





# Table of Contents

Welcome to the My Leviton family .....	5
Get started with Alexa .....	6
Use your voice to ask Alexa .....	7
Decora Smart Voice Dimmer .....	8
At a glance .....	9
Features .....	10
Your Voice Dimmer works with .....	11
Before you install .....	12
What you need to make it work .....	12
Identify your wires (single pole installation) .....	13
Wire your Voice Dimmer (single pole installation) .....	14
Identify your wires (3-way installation) .....	15
Common 3-way installation .....	16
Test .....	17
Install .....	18
Get the App .....	19
Launch the app .....	20
Add to your home network .....	20
Test app control .....	21
Just ask Alexa (test voice control) .....	22
Connect to My Leviton partners (optional) .....	23
What to do if .....	24
Factory default .....	25
Status light .....	25
Safety first .....	26
Warranty and compliance .....	27

 **We are here to help**



**CALL**

1-800-824-3005 (USA)

1-800-405-5320 (Canada)



**ONLINE**

[leviton.com/decorasmart](http://leviton.com/decorasmart)



**CHAT**

[www.leviton.com](http://www.leviton.com)



**EMAIL**

[dssupport@leviton.com](mailto:dssupport@leviton.com)



## Welcome to the My Leviton™ family



See the complete line of My Leviton™ app compatible  
dimmers, switches, plug-ins and controllers at  
[leviton.com/decorasmart](http://leviton.com/decorasmart)

 works with  
**my leviton**

**WEB VERSION**



amazon alexa

# Get Started with Alexa

---

You can talk to Alexa on your Decora Smart™ Voice Dimmer. With Alexa, you can ask to play music, hear the news, check weather, control smart home devices and more.

Download the My Leviton app from Apple App Store® or Google Play™ to set up Alexa on your Decora Smart Voice Dimmer.

*“Alexa, what’s in  
the news?”*

**WEB VERSION**



# Use Your Voice to Ask Alexa

## Smart Home

Control compatible devices such as lights, thermostats, TVs, locks and more.

*"Alexa, turn on the bedroom light."*

## News and Information

Ask Alexa for your flash news briefing, sports updates, weather reports and more.

*"Alexa, what's in the news?"*

## Timers and Alarms

Use Alexa to start a timer when cooking in the kitchen or set an alarm to wake up in the morning.

*"Alexa, set a timer for 15 minutes."*

## Announcements

Have Alexa announce important messages across all compatible Alexa devices in your home.

*"Alexa, announce that dinner is ready."*

## Music

Use Alexa to play music from a variety of music services.

*"Alexa, play jazz."*

## Fun and Games

Bring out Alexa's fun side by asking her to play a game or tell a joke.

*"Alexa, tell me a joke."*

## Get the Alexa App

The Alexa app lets you easily manage your alarms, music, shopping lists and more.

Go to **alexa.amazon.com** on your smartphone to get the app.

## Decora Smart™ Voice Dimmer

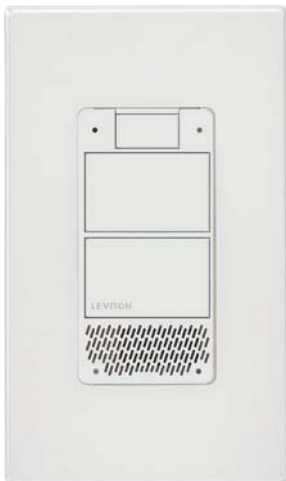

The Decora Smart Voice Dimmer with Amazon Alexa Built-in provides hands-free lighting control and the many benefits of Amazon Alexa Voice Services integrated directly into your home to make life simpler and easier.

Your Voice Dimmer connects to Wi-Fi and uses the My Leviton app. Combine your Voice Dimmer with other Decora Smart Wi-Fi devices to create an easy Wi-Fi lighting solution with built-in voice control, scheduling, lighting scenes and app control from anywhere.

US and foreign patents pending. Patents covering this product can be found at [leviton.com/patents](http://leviton.com/patents).





## At a glance

### Pull Tab

Pull out to disable power or reset your dimmer.

### Microphones

Picks up your voice for Alexa interaction.

### On/Bright Button

- Press once to turn on lights.
- Press and hold to brighten lights, then release when the desired lighting level is reached.

### Mics Off/On, Action Button

- Lights up to show Alexa status.
- Press to activate Alexa.
- Press and hold to turn off the mics. The status light will turn red. Press and hold again to turn mics back on.

### Speaker

Audio output for Alexa services.

### Off/Dim Button

- Press once to turn off lights.
- Press and hold to dim lights, then release when the desired lighting level is reached.

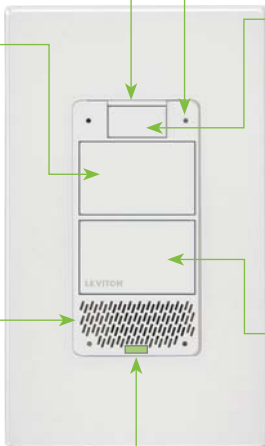

### Status Indicator Light

- Illuminates when the lights are off so you can find the dimmer in the dark.
- Provides connectivity and device status feedback.
- Advanced settings available in the My Leviton app.



## Features

### Full Range Dimming

Best-in-class dimming performance with custom settings in the My Leviton app for preset lighting levels, fade rates, bulb types and more.

### Single Pole or 3-Way/Multi-Location

Control the same lights from multiple locations using either the Decora Digital™ DD00R for remote dimming or the DD0SR for remote switching.

### Off Means Off

Ensures low-wattage LED bulbs always turn off.

### Language Support

Alexa interaction in English, Spanish and French.

For more information and features visit:

[leviton.com/decorasmart](https://leviton.com/decorasmart)



## Your Voice Dimmer works with:

Your Voice Dimmer is compatible with dimmable LED, dimmable CFL and incandescent bulbs. Your Voice Dimmer should not be used with electronic low voltage, motor loads or aluminum wire.

To ensure proper communication do not use metal wallplates.

For LED compatibility recommendations, go to [leviton.com/LED](http://leviton.com/LED).

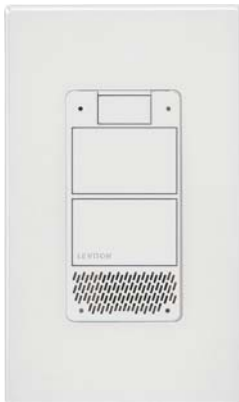

RATINGS	
LED / CFL	300W - 120VAC, 50/60Hz
Incandescent	300W - 120VAC, 50/60Hz
NETWORK	
Wi-Fi	802.11 a/b/g/n @ 2.4GHz
Security	WPA or WPA2
Bluetooth	v4.1



## Before you install

Installation requires electrical knowledge.  
If you are unsure of any steps, consult an electrician.

### Things to consider:

If light(s) are controlled from more than one location, you will need a Decora Digital Remote. See page 16 or the Leviton DD00R or DD0SR remote installation manual for wiring instructions.



- Use a DD00R for remote dimming.
- Use a DD0SR for remote switching.



## What you need to make it work

To install and use your Voice Dimmer:



- A 2.4GHz Wi-Fi network with high speed internet.



- An iOS (11.0 or later) or Android (6.0 or later) mobile device. NOTE: Make sure Wi-Fi and Bluetooth are enabled on your mobile device.



- A My Leviton™ cloud account set up through the My Leviton app.



- An active Amazon account to enable Alexa.



## Identify your wires

(for single pole installation)

**NOTE:** Before you wire, check to **make sure a strong Wi-Fi signal is present** at the location where you want to install your Voice Dimmer.

**WARNING: TO AVOID FIRE, SHOCK OR DEATH, turn off power at the circuit breaker.**

1. Remove wallplate and disconnect switch.
2. Ensure disconnected wires are not touching.
3. Restore power. Carefully test wires with voltage tester to find the hot (line) wire.
4. **Turn off power at the circuit breaker.**
5. Mark the wires as shown:

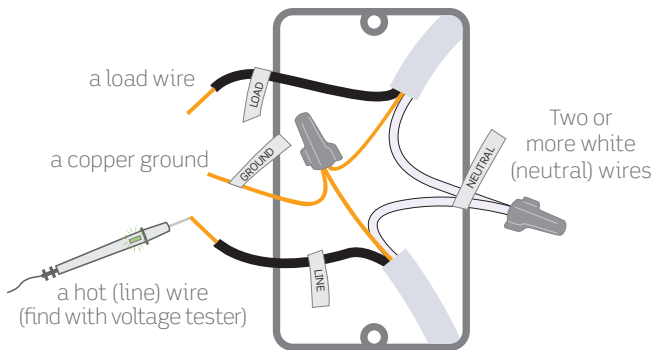

**If your wall box contains a different wiring configuration, contact Leviton tech support or consult an electrician.**



## Wire your Voice Dimmer

### Single Pole Installation

1. Work on only one connection at a time.
2. Connect wires as shown.

**NOTE:** Neutral connection is required.

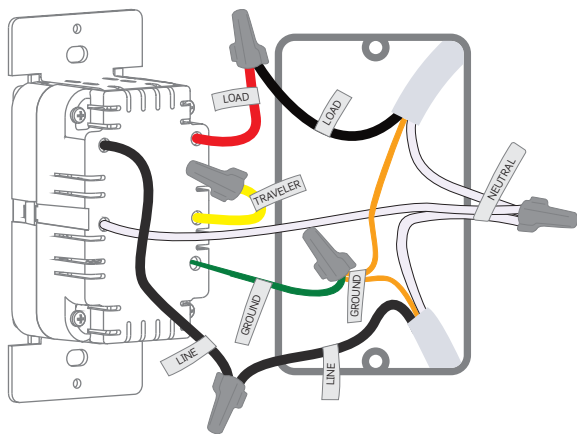

**If your wall box contains a different wiring configuration, contact Leviton tech support or consult an electrician.**

WEB VERSION



## Identify your wires

(for 3-way installation)

**NOTE:** Before you wire, check to **make sure a strong Wi-Fi signal is present** at the location where you want to install your Voice Dimmer.

**WARNING: TO AVOID FIRE, SHOCK OR DEATH, turn off power at the circuit breaker.**

1. Remove wallplate and disconnect switch.
2. Ensure disconnected wires are not touching.
3. Restore power. Carefully test wires with voltage tester to find the hot (line) wire.
4. **Turn off power at the circuit breaker.**
5. Mark the wires as shown:

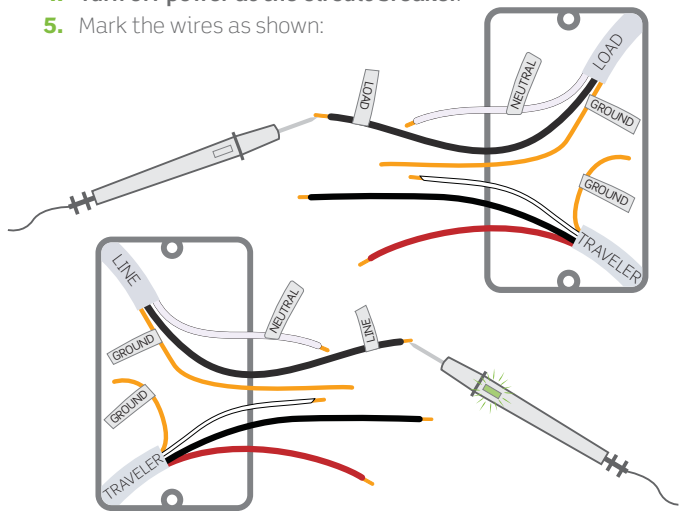

**If your wall box contains a different wiring configuration, contact Leviton tech support or consult an electrician.**



## Common 3-way installation

Use the wiring method below to install your Voice Dimmer in the same wall box as the load connection.

1. Work on only one connection at a time.
2. Connect wires as shown.

**NOTE:** Neutral connection is required.

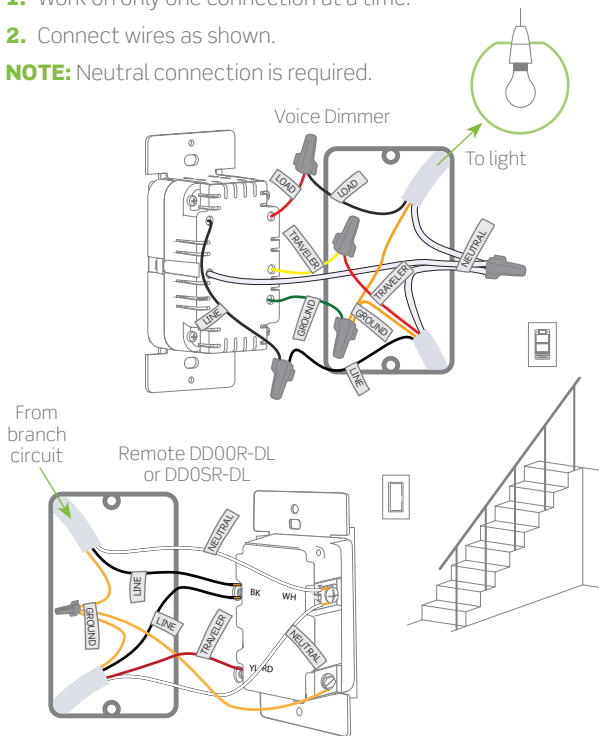

If your wall box contains a different wiring configuration, contact Leviton tech support or consult an electrician.





## Test

Restore power. Status light should flash green indicating your Voice Dimmer is ready to be configured.

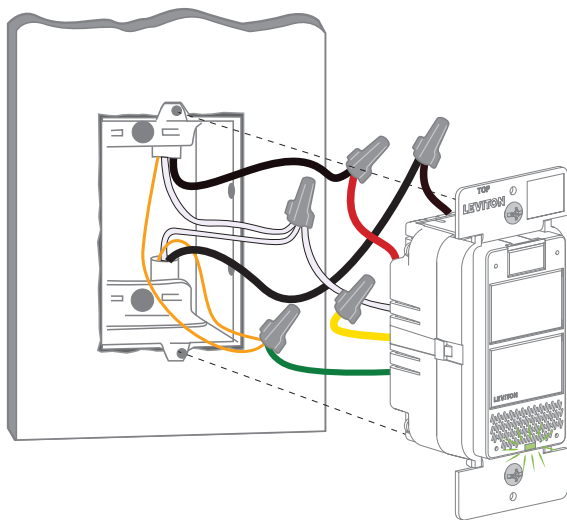

\*Single pole wiring shown.



## Install

Turn off power at circuit breaker before proceeding.

1. Gently push wires into wall box.  
Screw Voice Dimmer to box.

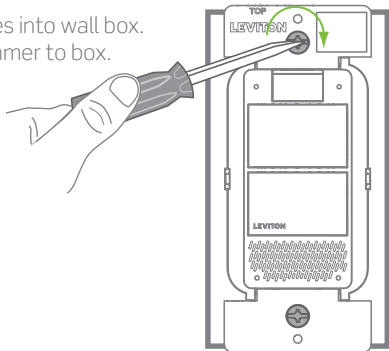

2. Snap on Decora® wallplate.  
Restore power.

3. Test control of your lights  
by pressing the ON and OFF  
buttons.

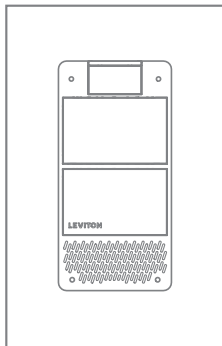

**Congratulations!**  
**Your Decora Smart™ Voice Dimmer**  
**is ready to be added to your Wi-Fi network.**

**WEB VERSION**



# Get the app

Visit [my.leviton.com](http://my.leviton.com) and select the link for your smartphone or tablet.

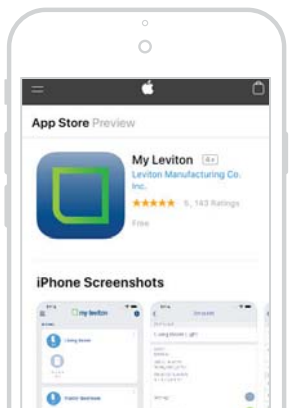

WEB VERSION



## Launch the app



1. Launch the My Leviton app.
2. Log in or choose Sign Up for an Account.
3. Follow the instructions on the screen.



## Add to your home network

1. Select the **+** in the upper right corner to add a device.

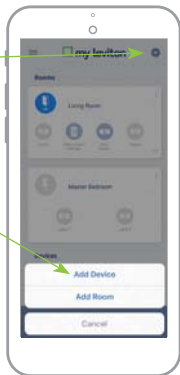

WEB VERSION

2. Select Voice Dimmer.
3. Follow the app instructions to set up your Voice Dimmer and register with Amazon Alexa.



## Test app control

1. Open the My Leviton app.
2. Tap icon to turn on and off.

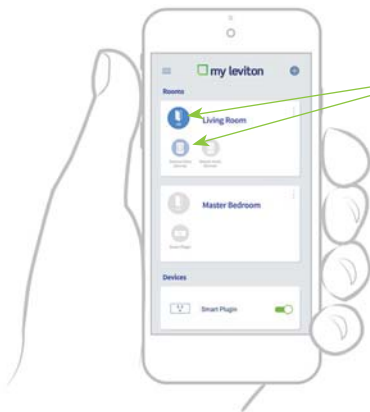



## Just Ask Alexa

### Test Voice Control

\*Make sure you have followed the steps in the My Leviton app to enable Alexa.

*"Alexa, turn on the kitchen lights."*



*"Okay, turning on the kitchen lights."*



alexabuilt-in

WEB VERSION



## Connect to My Leviton partners (optional)

Visit [my.leviton.com](http://my.leviton.com) for a complete list of compatible smart home products.

To integrate with another service:

1. Tap menu icon in upper left corner.

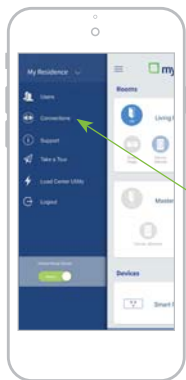

2. Tap Connections, choose desired service and follow app instructions.

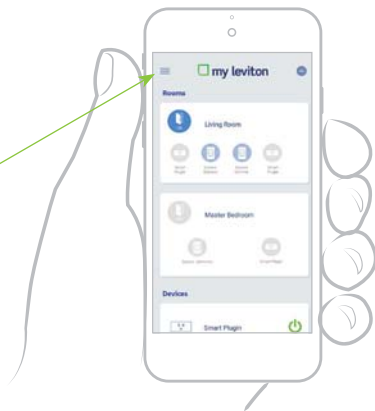



## What to do if...

If your Voice Dimmer is not performing as expected, visit [leviton.com/decorasmart](http://leviton.com/decorasmart) or contact technical services.

### ➔ **Alexa is not working:**

- Using the My Leviton app, select your Voice Dimmer, then select "Device Settings." On the "Device Info" screen select "Reconfigure."
- Follow the prompts to configure your Voice Dimmer and enable Alexa.

### ➔ **Not connected to Wi-Fi:**

- Using the My Leviton app, select your Voice Dimmer, then select "Device Settings." On the "Device Info" screen select "Reconfigure."
- Follow the prompts to configure your Voice Dimmer and update the Wi-Fi settings.

### ➔ **Indicator lights are on but light fixture is off and does not respond:**

- Check wiring to confirm hot, neutral, and load.
- Ensure the white conductor is a neutral.

### ➔ **Lights flicker at low end of dimming range:**

- Use the My Leviton app to increase the minimum dim level.

### ➔ **Intermittent dimmer operation:**

- Confirm the load does not exceed its ratings.

### ➔ **To place the Voice Dimmer into Setup Mode:**

- Hold the ON and OFF button together for 7 seconds.





## Factory default

To reset to factory settings:

1. Hold the ON and OFF button together for 7 seconds.
2. Release when the status light starts flashing green.
3. Press and hold the ON button for 7 seconds. Release when the status light flashes red/amber and the dimmer will reset.

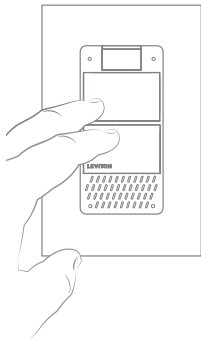

## Status light

COLOR	ACTIVITY	STATUS
Green	Flashing	In setup mode and ready to be added to a Wi-Fi network
Green	Slow Blink	Connecting or re-connecting to a Wi-Fi network
Green or Off	Solid	Normal operation; can be configured in setup
Amber	Slow Blink	Dimmer was not able to connect to the Wi-Fi network
Green, Red, Amber	Flashing	Identify feature triggered from the My Leviton app

Please see [my.leviton.com](http://my.leviton.com) support for additional diagnostic assistance.



## Safety first

**WARNING: TO AVOID FIRE, PERSONAL INJURY OR DEATH DO NOT USE** for the control of high power heating appliances such as portable heaters. There can be unexpected consequences if not used with care. For example, an empty coffee pot can be remotely turned on. If that should happen, your coffee pot could be damaged from overheating. If an electric heater is turned on by remote control while clothing is draped over it, a fire could result. This module will not control lighting that is used with electronic low-voltage and high frequency power supply transformers, nor high pressure discharge lamps (HID lighting). This includes mercury-vapor, sodium vapor and metal halide lamps.

### WARNINGS:

- This product is to be installed and/or used in accordance with electrical codes and regulations.
- Indoor use only.
- If you are unsure about any part of these instructions, consult an electrician.
- Unplug unit when servicing loads.
- Save this instruction sheet. It contains important technical data along with testing and troubleshooting information which will be useful after installation is complete.

### CAUTION:

- Leviton Wi-Fi enabled devices rely on Wi-Fi communication. Increasing the number of Wi-Fi devices can affect Wi-Fi performance. Consult the network's wireless access point specifications to determine the maximum number of supported Wi-Fi devices. For installations with a large number of Leviton Wi-Fi devices, a high performance wireless access point capable of supporting a large number of devices may be required.

### ADDITIONAL RATINGS:

- Purpose of control: Operating Control
- Action Control Type: 1
- Pollution Degree: 2
- Impulse Voltage: 2500V
- Disconnection Type: Micro

# Limited 2 Year Warranty

For Leviton's limited product warranty, go to [www.leviton.com](http://www.leviton.com). For a printed copy of the warranty, call 1-800-824-3005.

US and foreign patents pending. Patents covering this product can be found at [Levoton.com/patents](http://Levoton.com/patents). This product includes certain open source software. For more information and instructions on how to obtain a copy, go to the website [my.leviton.com/opensource](http://my.leviton.com/opensource).

## FOR CANADA ONLY

For warranty information and/or product returns, residents of Canada should contact Leviton in writing at Leviton Manufacturing of Canada Ltd to the attention of the Quality Assurance Department, 165 Hymus Blvd, Pointe-Claire (Quebec), Canada H9R 1E9 or by telephone at 1-800-405-5320.

## FCC COMPLIANCE STATEMENT

The enclosed device complies with Part 15 of the FCC Rules. Operation is subject to the following two conditions: (i.) This device may not cause harmful interference (ii.) This device must accept any interference received, including interference that may cause undesired operation. Any changes or modifications not expressly approved by Leviton could void the user's authority to operate this equipment. This equipment has been tested and found to comply with the limits for a Class B digital device, pursuant to part 15 of the FCC Rules. These limits are designed to provide reasonable protection against harmful interference in a residential installation. This equipment generates uses and can radiate radio frequency energy and, if not installed and used in accordance with the instructions, may cause harmful interference to radio communications. However, there is no guarantee that interference will not occur in a particular installation. If this equipment does cause harmful interference to radio or television reception, which can be determined by turning the equipment off and on, the user is encouraged to try to correct the interference by one or more of the following measures:

- Reorient or relocate the receiving antenna.
- Increase the separation between the equipment and receiver.
- Connect the equipment into an outlet on a circuit different from that to which the receiver is connected.
- Consult the dealer or an experienced radio/TV technician for help.

## FCC CAUTION

Any changes or modifications not expressly approved by Leviton Manufacturing Co., Inc., could void the user's authority to operate the equipment.

## FCC SUPPLIER'S DECLARATION OF CONFORMITY:

Model DWVAA – Decora Voice™ Dimmer with Amazon Alexa Built-In is manufactured by Leviton Manufacturing Co., Inc. 201 N. Service Road, Melville, NY 11747. This device complies with part 15 of the FCC Rules. Operation is subject to the following two conditions: (1) This device may not cause harmful interference, and (2) this device must accept any interference received, including interference that may cause undesired operation.

## IC STATEMENT

This device complies with Industry Canada license-exempt RSS standard(s). Operation is subject to the following two conditions: (1) this device may not cause interference, and (2) this device must accept any interference, including interference that may cause undesired operation of the device.

## RF EXPOSURE AND CO-LOCATION:

To comply with FCC OET Bulletin 65 and ICSED RF exposure limits for general population and uncontrolled exposure, this device shall be installed and operated with a minimum distance of 7.9 inches (20 cm) between the radiator and your body. Also, must not be co-located or operated in conjunction with any other antenna or transmitter.

## Copyright and Trademark Information

Decora is a registered trademark and Decora Smart is a trademark of Leviton Manufacturing Co., Inc. Wi-Fi, Google Play, Android, App Store, Apple iOS and Google Assistant are the trademarks of their respective owners and any use of such marks by Leviton is under license. Alexa, and related logos are trademarks of Amazon.com, Inc. or its affiliates. Use herein of other third party trademarks, service marks, trade names, brand names and/or product names are for informational purposes only, are/may be the trademarks of their respective owners; such use is not meant to imply affiliation, sponsorship, or endorsement. No part of this document may be reproduced, transmitted or transcribed without the express written permission of Leviton Manufacturing Co., Inc.

Copyright 2020 Leviton Mfg. Co., Inc.

## If you need help...



### CALL

1-800-824-3005 (USA)

1-800-405-5320 (Canada)



### ONLINE

[leviton.com/decorasmart](http://leviton.com/decorasmart)



### CHAT

[www.leviton.com](http://www.leviton.com)



### EMAIL

[dssupport@leviton.com](mailto:dssupport@leviton.com)

Leviton Manufacturing Co., Inc.  
201 North Service Road, Melville, NY 11747  
Telephone: 1-800-824-3005

Visit Leviton's website at [www.leviton.com](http://www.leviton.com)  
© 2020 Leviton Manufacturing Co., Inc. All rights reserved.

Specifications subject to change at any time without notice.

**WEB VERSION**